

1. ZONING DISTRICT: B-2, R-1
2. REFERENCES USED:
 - Assessor's Map # 49, Block # 552, Lot # 6
 - Deed Book: 32167 - Page: 417
 - Plan No. 184 of 1954
 - Plan No. 1070 of 1963
 - See also Plan located at the End of Deed Book: 1594 (Recorded at the Norfolk County Registry of Deeds)
3. THIS PLAN IS BASED ON AN "ON GROUND" SURVEY.
4. NO NEW GRADES ARE BEING PROPOSED.

EXISTING

TOTAL LOT AREA = 14,447.0 S.F.
EXISTING BUILDING FOOTPRINTS = 2,035.0 S.F. ✓
EXISTING LOT COVERAGE = 14.08 %
EXISTING USABLE OPEN SPACE = 85.92 %

PROPOSED

EXISTING BUILDING FOOTPRINTS = 2,035.0 S.F.
PROPOSED ADDITION FOOTPRINTS = 680.0 S.F. ○
PROPOSED LOT COVERAGE = 18.79 %
PROPOSED USABLE OPEN SPACE = 81.21 %

120-40
NOT MAKING MORE
FOR COMPETING DUE TO
BORROWING LOCATION
120-101 - REGULATING DECOMMISSION
- MUST FOR 120-101(6)
SOS1 AUTO

SITE PLAN

Showing a proposed addition
on an existing service station

4 HOLLIS STREET, WEYMOUTH, MA

Prepared for: LG Kairouz LLC
Surveyed by: Michel G. El-Ashkar, PLS

Scale: 1" = 20 ft.

Date: May 10, 2021

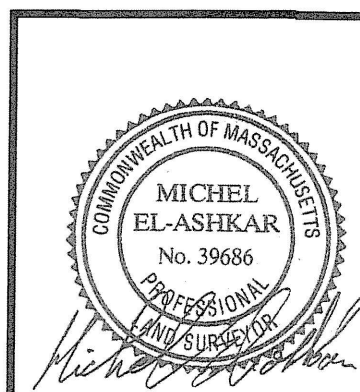

FILE No. 2021-03-17

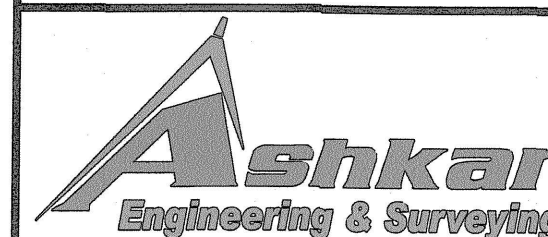

70 Washington Street
Suite 306
Haverhill, MA 01832
ph: (978) 914-6527
fax: (978) 914-6528
www.ashkarsurveying.com

SHEET 1 OF 1