

Topography in the vicinity of  
the Billboard Corridor near  
Finnell Drive

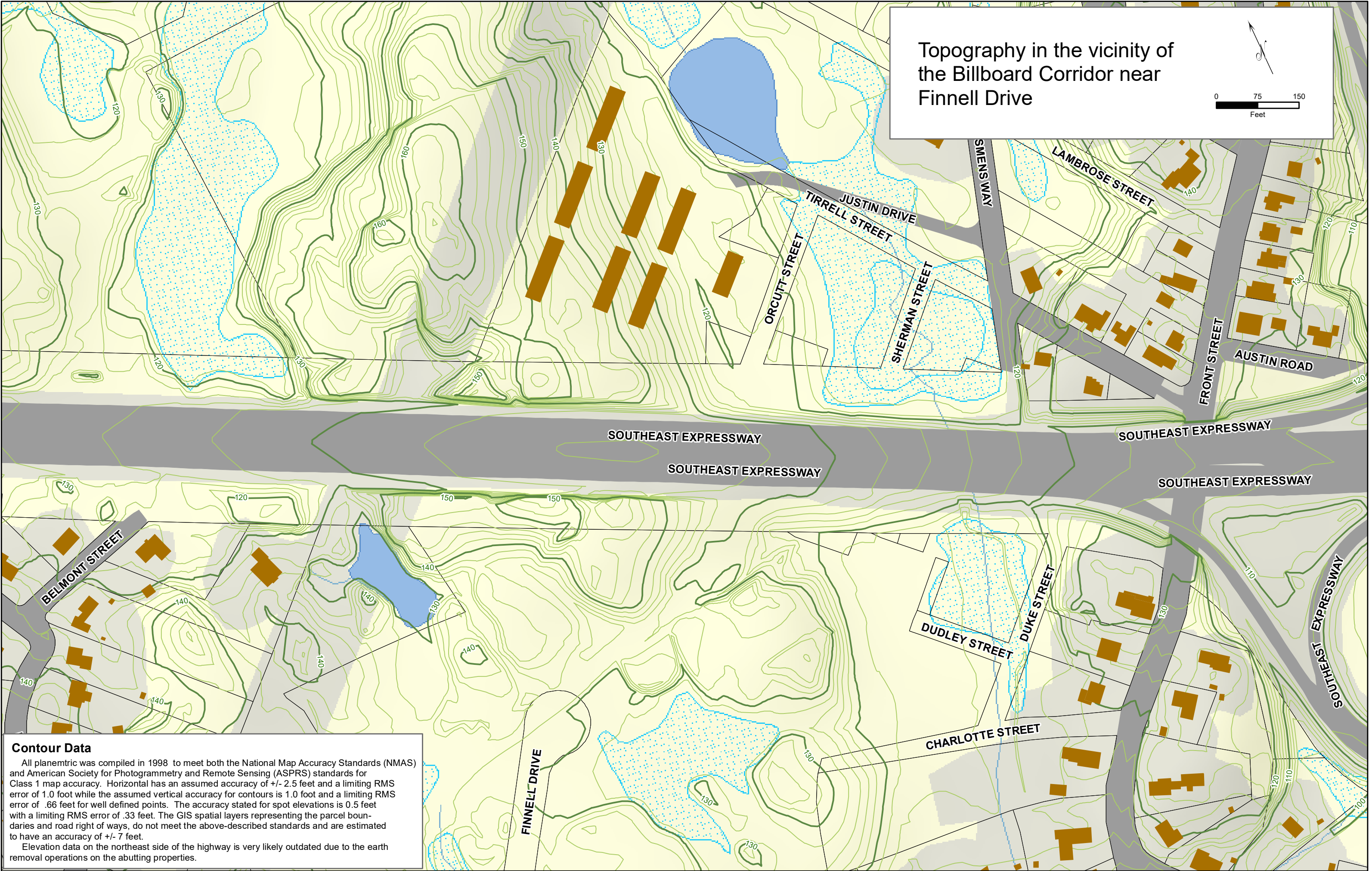
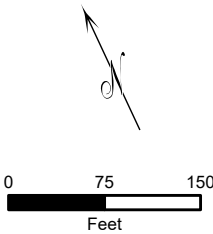

**Contour Data**

All planemtric was compiled in 1998 to meet both the National Map Accuracy Standards (NMAS) and American Society for Photogrammetry and Remote Sensing (ASPRS) standards for Class 1 map accuracy. Horizontal has an assumed accuracy of +/- 2.5 feet and a limiting RMS error of 1.0 foot while the assumed vertical accuracy for contours is 1.0 foot and a limiting RMS error of .66 feet for well defined points. The accuracy stated for spot elevations is 0.5 feet with a limiting RMS error of .33 feet. The GIS spatial layers representing the parcel boundaries and road right of ways, do not meet the above-described standards and are estimated to have an accuracy of +/- 7 feet.

Elevation data on the northeast side of the highway is very likely outdated due to the earth removal operations on the abutting properties.