



# PROPOSED BUILDING EXPANSION

1047 WASHINGTON STREET / 0 WASHINGTON STREET - WEYMOUTH, MASSACHUSETTS

## NOTICE OF INTENT SUBMITTAL

**VERTEX**  
400 Libbey Parkway | Weymouth, MA 02189  
Main: 781.952.6000 | VERTEXENG.COM



### SHEET INDEX

- C0.0 COVER SHEET
- C1.0 SITE PLAN
- C2.0 SITE DETAILS
- C2.1 SITE DETAILS

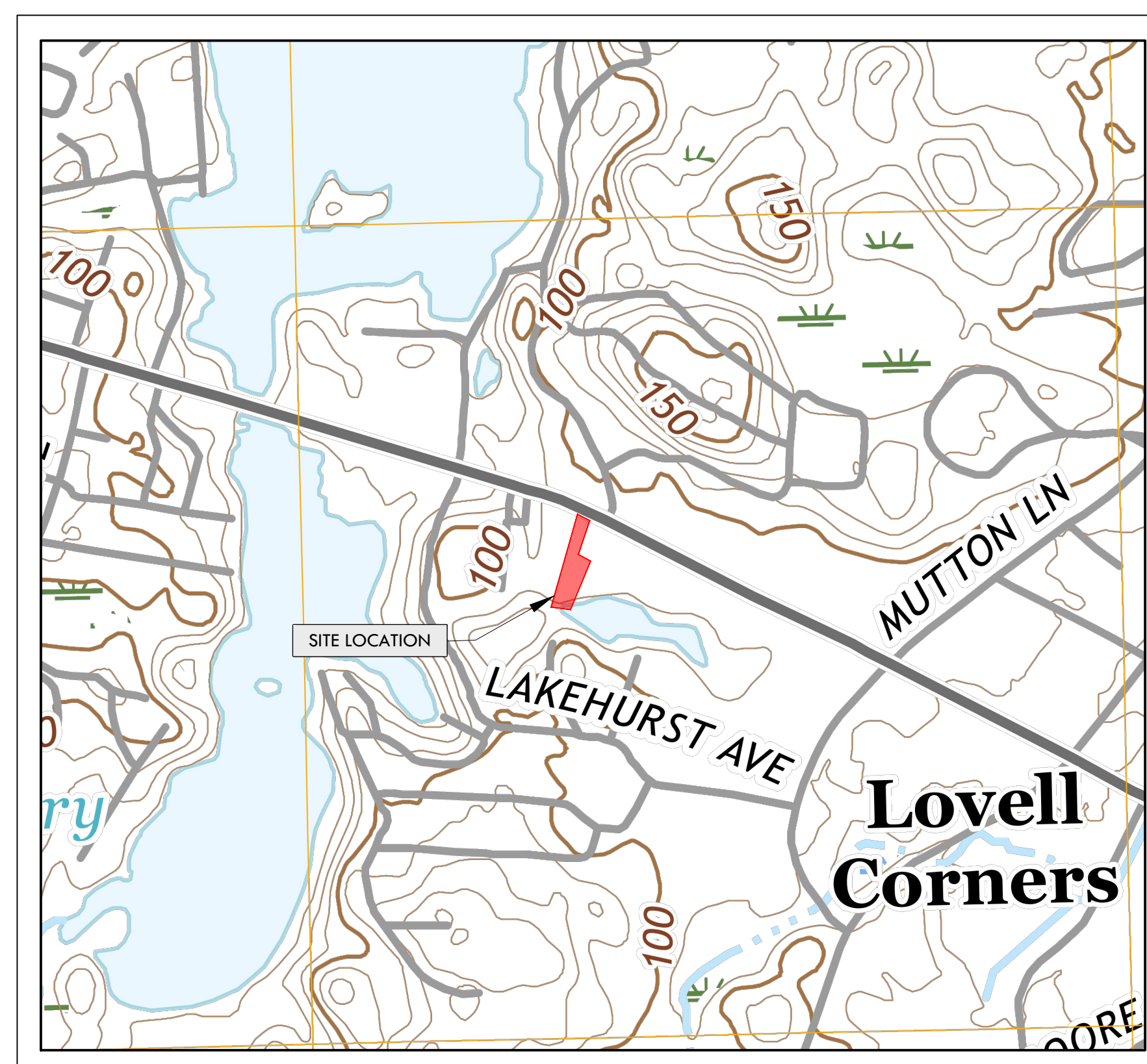

— AREA MAP —  
SCALE: 1"= 500'

#### APPLICANT

**JOE GRATTA**  
1047 Washington Street  
Weymouth, MA 02189  
Tel: (781) 335-8635

#### CIVIL ENGINEERS

**THE VERTEX COMPANIES, INC.**  
400 Libbey Parkway  
Weymouth, MA 02189  
Tel: (781) 952-6000  
Fax: (781) 335-3543

COVER SHEET

SITE: 1047 WASHINGTON STREET /  
0 WASHINGTON STREET  
WEYMOUTH, MASSACHUSETTS 02189  
FOR: JOE GRATTA  
1047 WASHINGTON STREET  
WEYMOUTH, MASSACHUSETTS 02189

NO.	REVISIONS
1	10/29/2020 - CONCOM
2	
3	
4	
5	
6	
7	
8	
9	
10	

DATE: 10/29/2020	<b>C0.0</b>
DRAWN BY: JJA	
CHECKED BY: AJC	
JOB #: 64380	

811

Know what's below.  
Call before you dig.

**VERTIX**  
400 Libbey Parkway | Weymouth, MA 02189  
Main: 781.952.6000 | VERTEXENG.COM

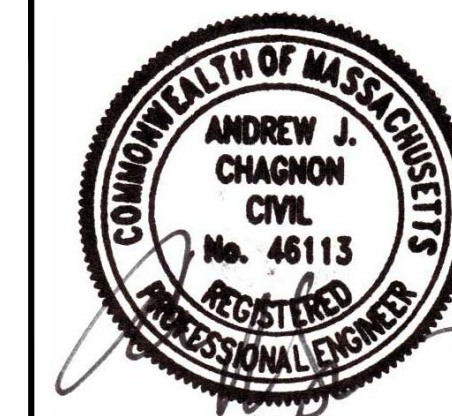

10/29/2020

**SITE PLAN**  
SITE: 1047 WASHINGTON STREET /  
0 WASHINGTON STREET  
WEYMOUTH, MASSACHUSETTS 02189  
FOR: JOE GRATTA  
1047 WASHINGTON STREET  
WEYMOUTH, MASSACHUSETTS 02189

NO.	REVISIONS
1	10/29/2020 - CONCOM
2	
3	
4	
5	
6	
7	
8	
9	
10	

DATE: 10/29/2020	<b>C1.0</b>
DRAWN BY: JJA	
CHECKED BY: AJC	
JOB #: 64380	

- EXISTING LEGEND**
- WETLAND BOUNDARY
  - EDGE OF ROAD
  - CURB LINE
  - ELEC --- UNDERGROUND ELECTRIC
  - OVHD --- OVERHEAD ELECTRIC WIRE
  - ST --- UNDERGROUND STORMWATER
  - W --- UNDERGROUND WATER
  - 80 --- CONTOUR
  - ⊕ WLF --- WETLAND FLAG
- 
- PROPOSED LEGEND**
- EROSION CONTROL/LIMIT OF DISTURBANCE
  - CONTOUR - MAJOR
  - CONTOUR - MINOR

- NOTES**
- EXISTING CONDITIONS INFORMATION FROM "PLAN OF LAND" PREPARED BY C.S. KELLEY SURVEYORS (NO DATE) AND PROVIDED BY ATLANTIC MECHANICAL.
  - WETLAND DELINEATION BY WETLAND STRATEGIES, INC., PLYMOUTH MA, PER REPORT DATED AUGUST 11, 2020.

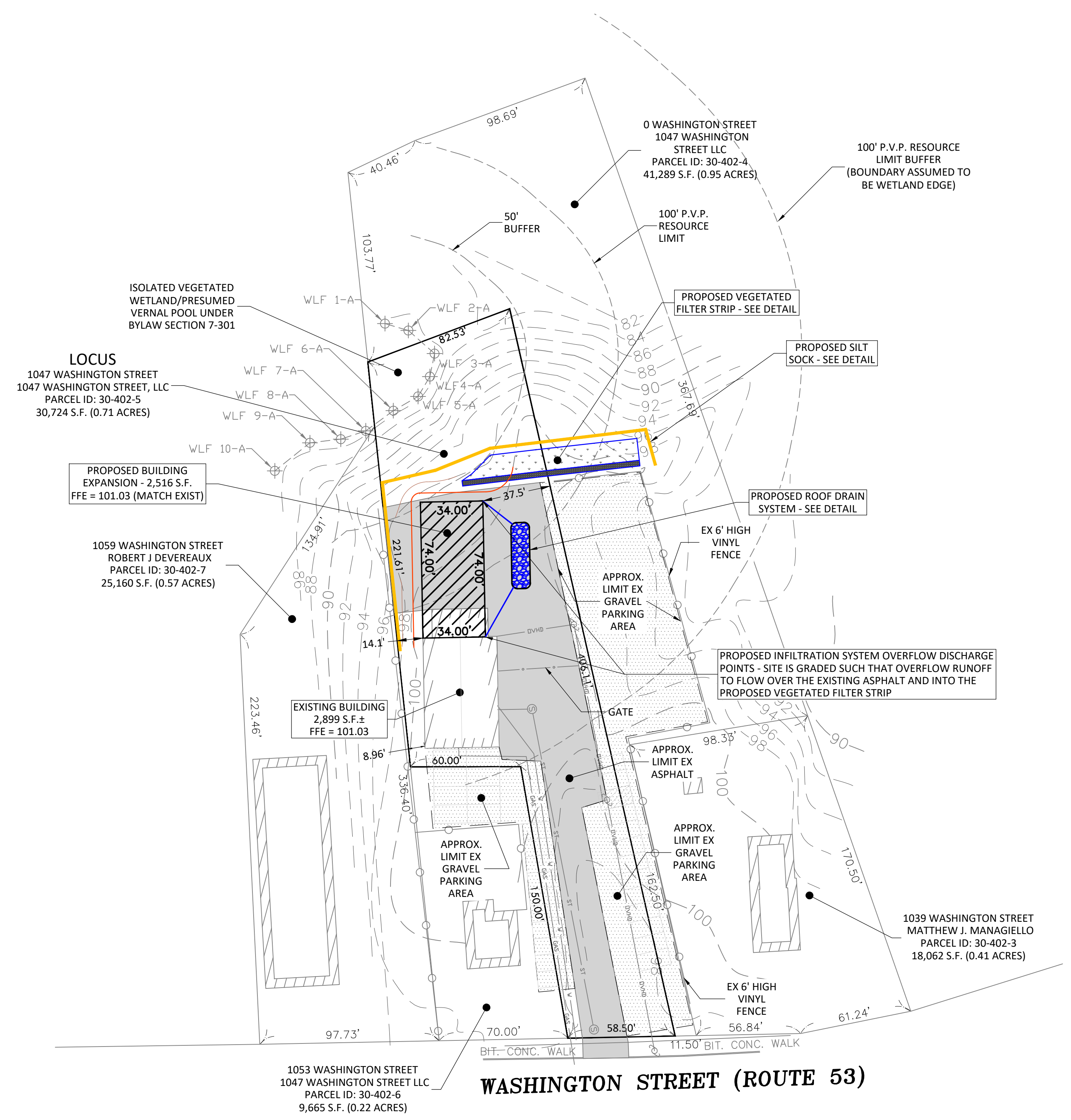

Z:\Shared\Projects\64000-64999\64300-64380\Paul Gratta Weymouth, MA\05-Engineering\Vertex Drawings\C1.0 - Site Plan\_V2.dwg, Thursday, October 29, 2020 12:38:35 PM  
Copyright © 2020 The Vertix Companies, Inc.



Know what's below.  
Call before you dig.

**VERTEX**  
400 Libbey Parkway | Weymouth, MA 02189  
Main: 781.952.6000 | VERTEXENG.COM

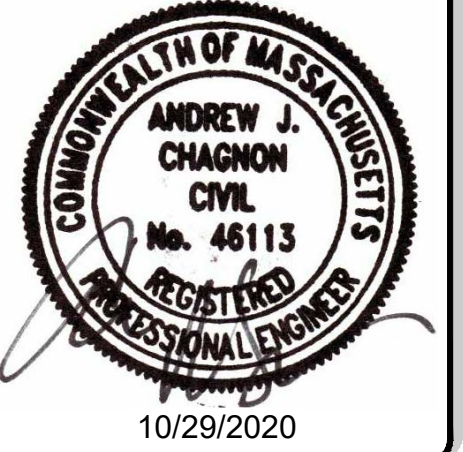

### A SILTATION BARRIER

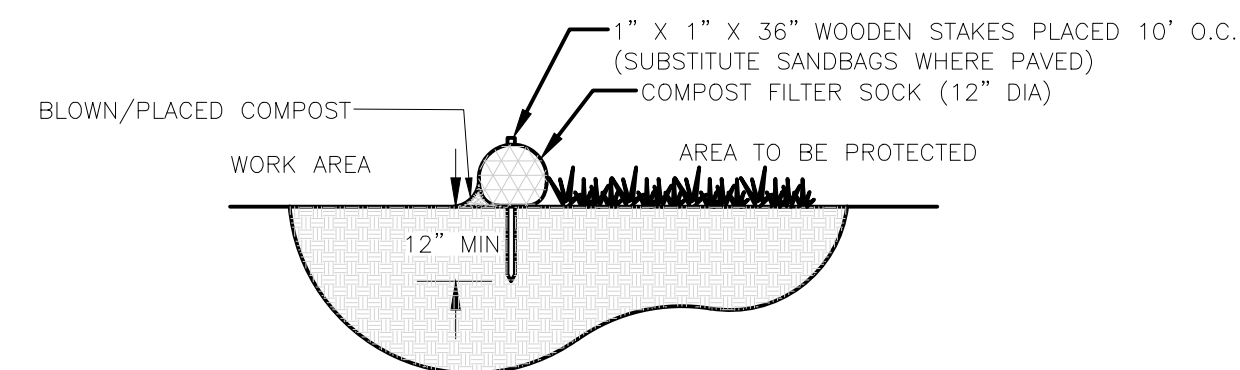

SECTION

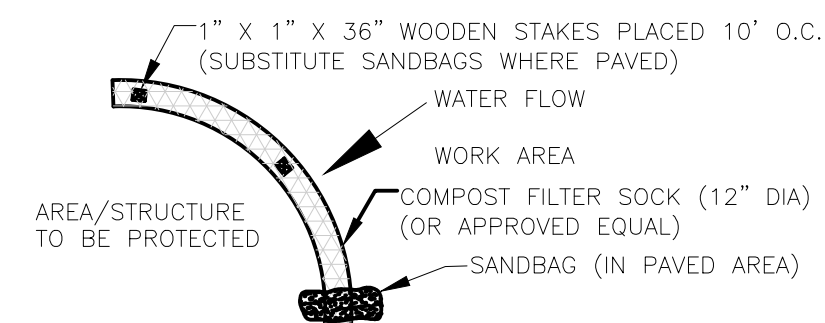

PLAN

- NOTES:
1. INSPECT AND MAINTAIN THROUGHOUT CONSTRUCTION.
  2. SOCK AND COMPOST MATERIAL TO BE REMOVED FROM SITE WHEN CONSTRUCTION COMPLETE.

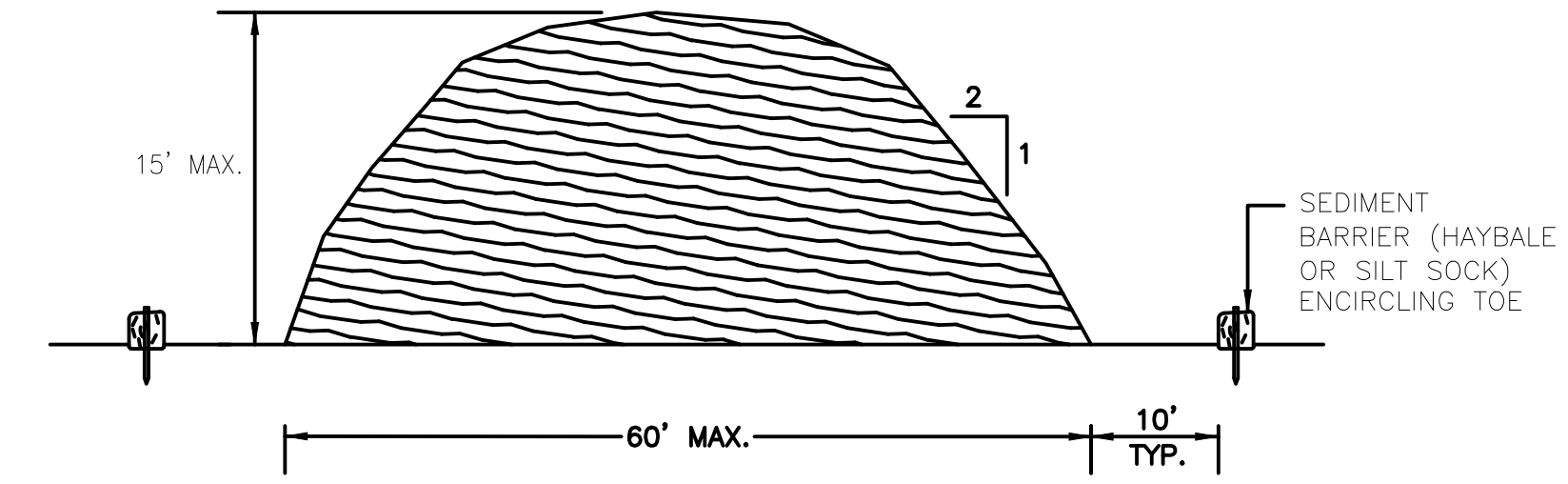

### NOTES:

1. STOCKPILE AREA SHALL NOT EXCEED SPECIFIED DIMENSIONS WITHOUT APPROVAL FROM ENGINEER.
2. STOCKPILED ERODIBLE MATERIAL THAT WILL NOT BE USED FOR GREATER THAN 30 DAYS SHALL BE STABILIZED WITH TEMPORARY VEGETATION OR COVERED IMMEDIATELY FOLLOWING PLACEMENT.
3. NO STOCKPILE SHALL BE PLACED WITHIN THE 100 FOOT WETLAND BUFFER.

### ERODIBLE MATERIAL STOCKPILE

NOT TO SCALE

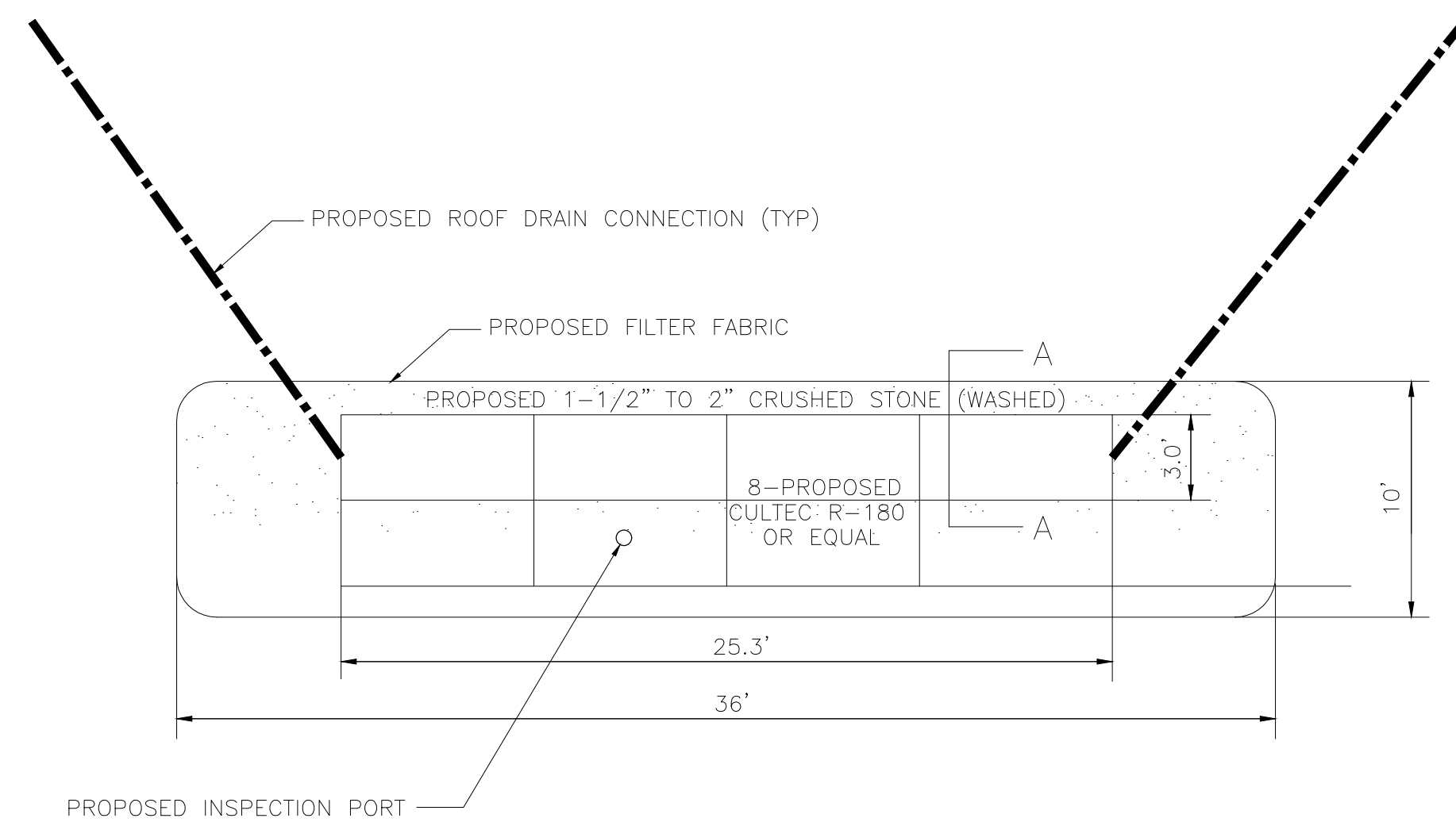

ROOF DRAIN SYSTEM — PLAN VIEW  
(NOT TO SCALE)

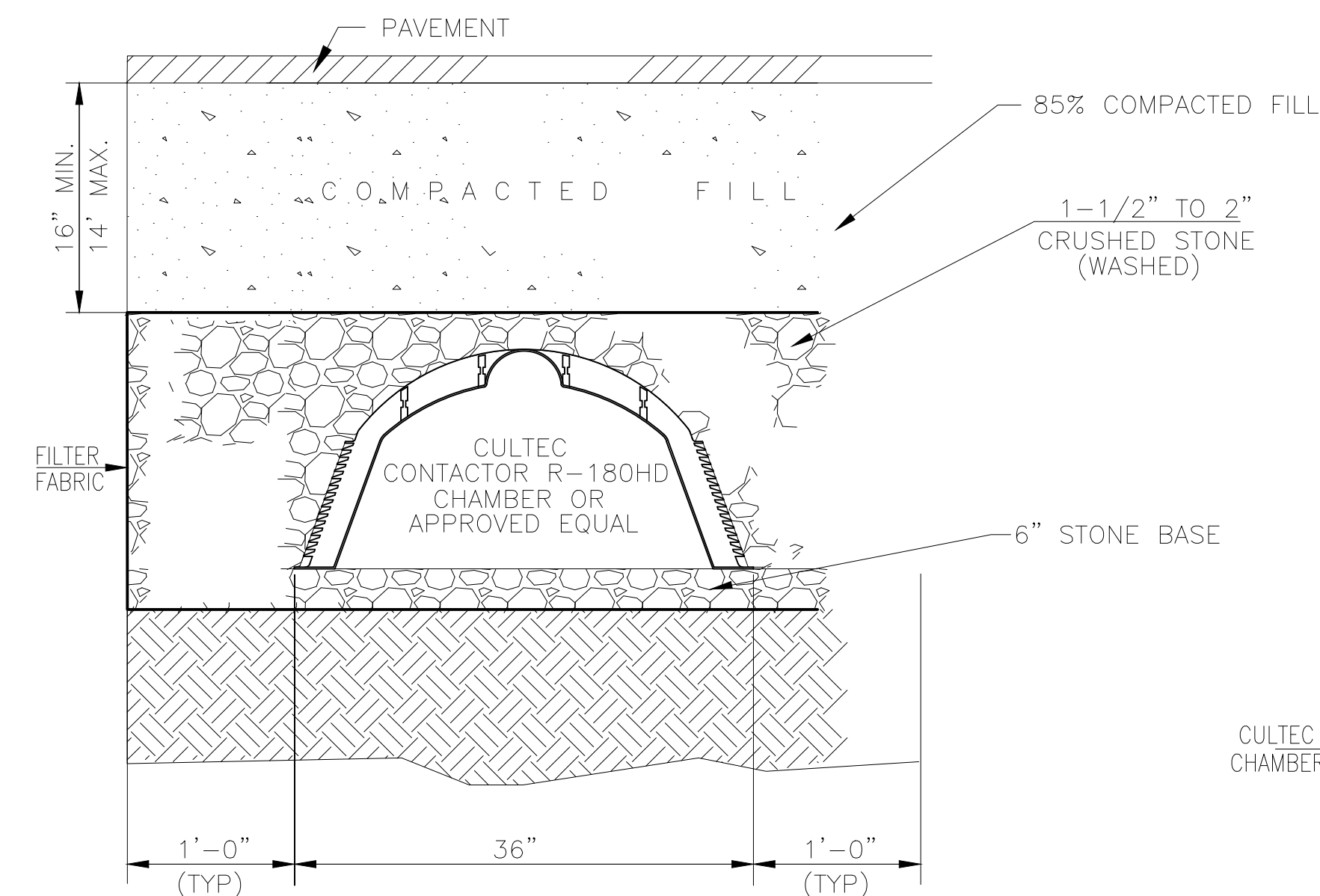

SECTION A-A — TYPICAL ROOF DRAIN SYSTEM  
(NOT TO SCALE)

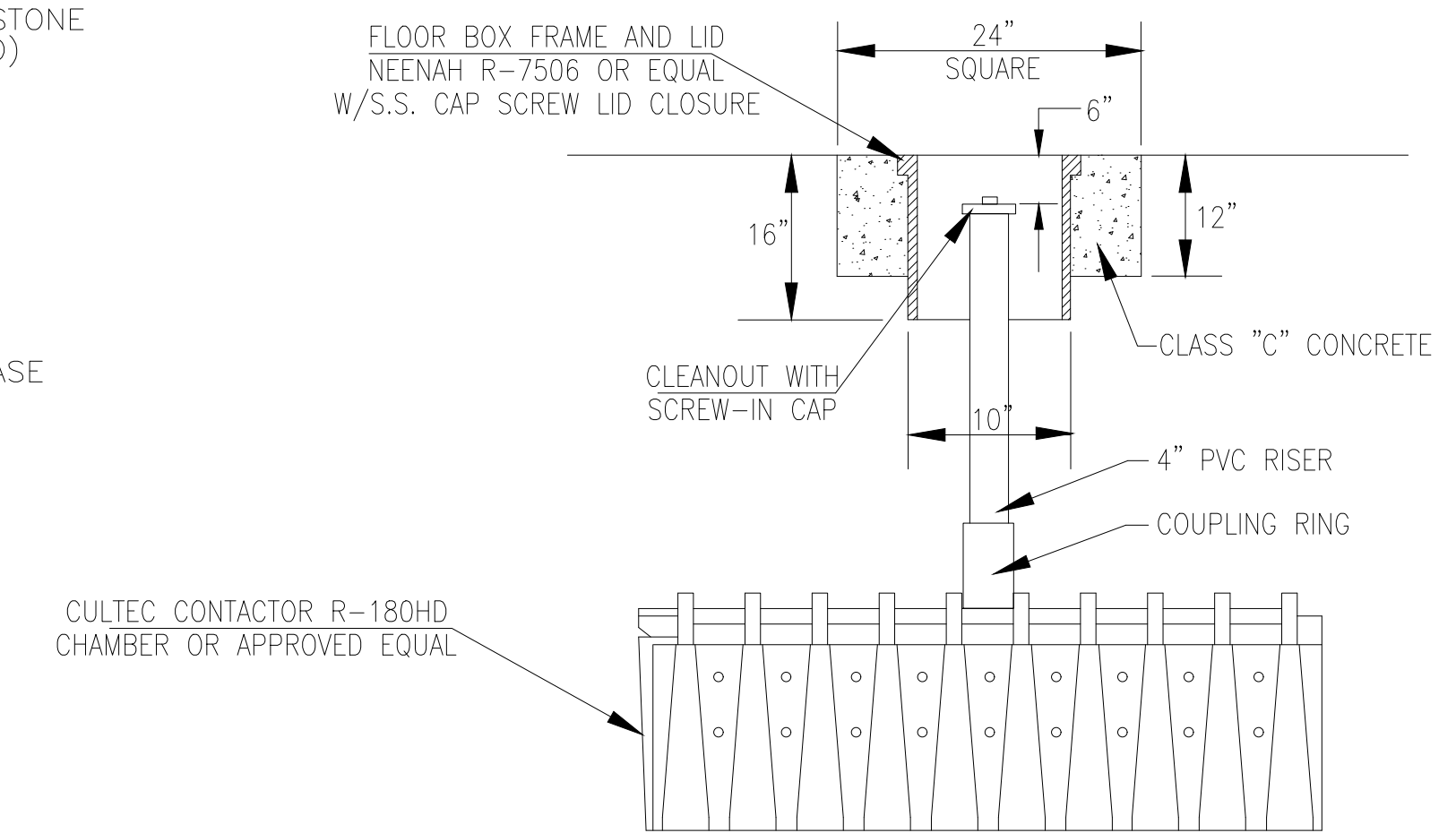

DETAIL — INSPECTION PORT  
@ ROOF DRAIN SYSTEM  
(NOT TO SCALE)

### SITE DETAILS

SITE: 1047 WASHINGTON STREET /  
0 WASHINGTON STREET  
WEYMOUTH, MASSACHUSETTS 02189  
FOR: JOE GRATTA  
1047 WASHINGTON STREET  
WEYMOUTH, MASSACHUSETTS 02189

NO.	REVISIONS
1	10/29/2020 - CONCOM
2	
3	
4	
5	
6	
7	
8	
9	
10	

DATE: 10/29/2020	<b>C2.0</b>
DRAWN BY: JJA	
CHECKED BY: AJC	
JOB #: 64380	



Know what's below.  
Call before you dig.

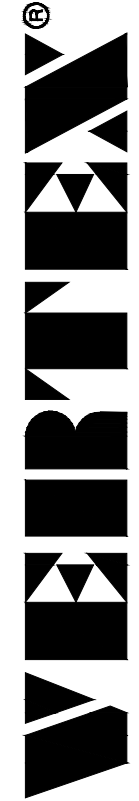

400 Libbey Parkway | Weymouth, MA 02189  
Main: 781.952.6000 | VERTEXENG.COM

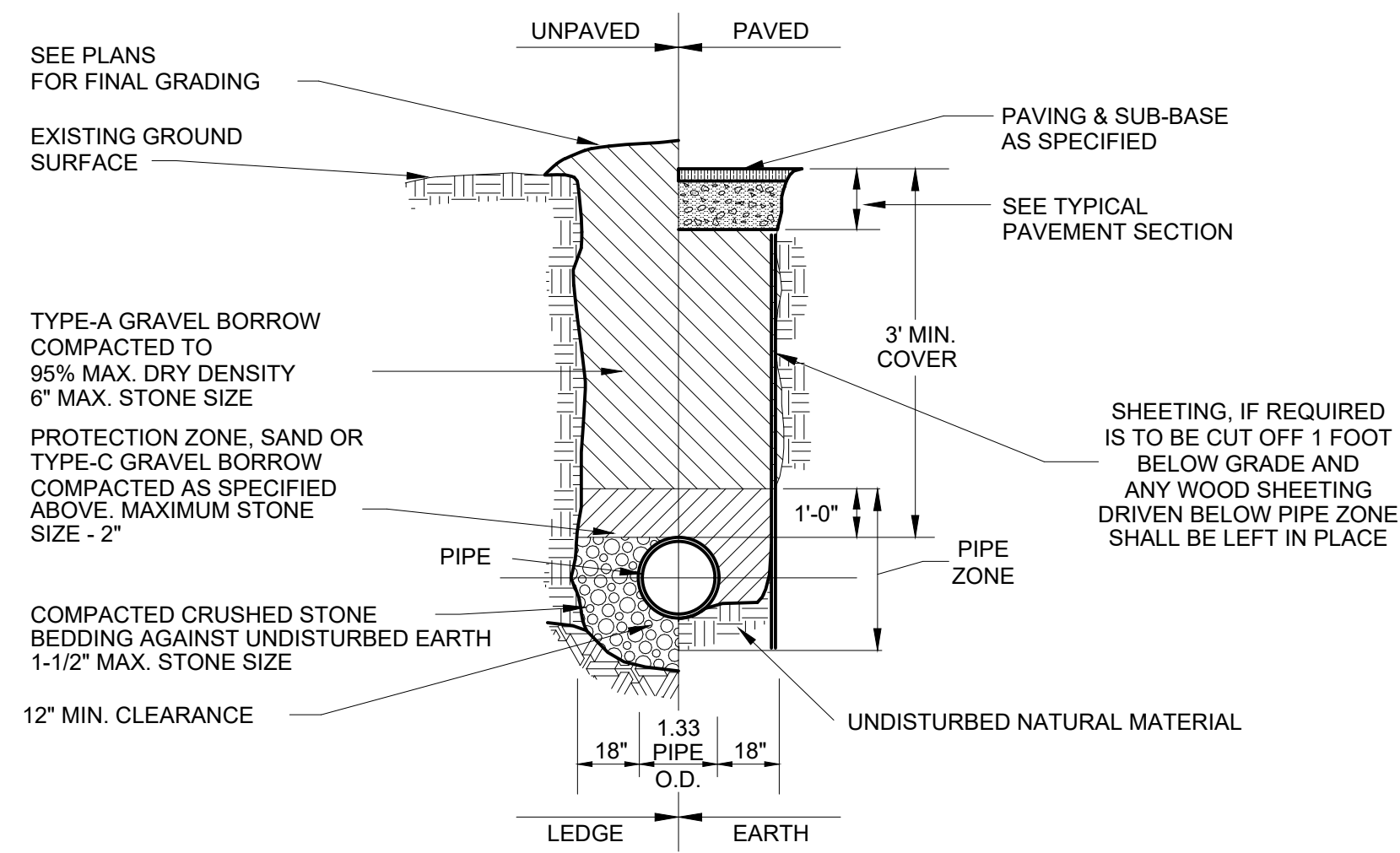

### TYPICAL UTILITY TRENCH DETAIL

(NOT TO SCALE)

1. GRAVEL BORROW SHALL CONFORM TO MASS HIGHWAY SPECIFICATION M1.03.0.
2. CRUSHED STONE BEDDING SHALL CONFORM TO MASS HIGHWAY SPECIFICATION M2.01.1.

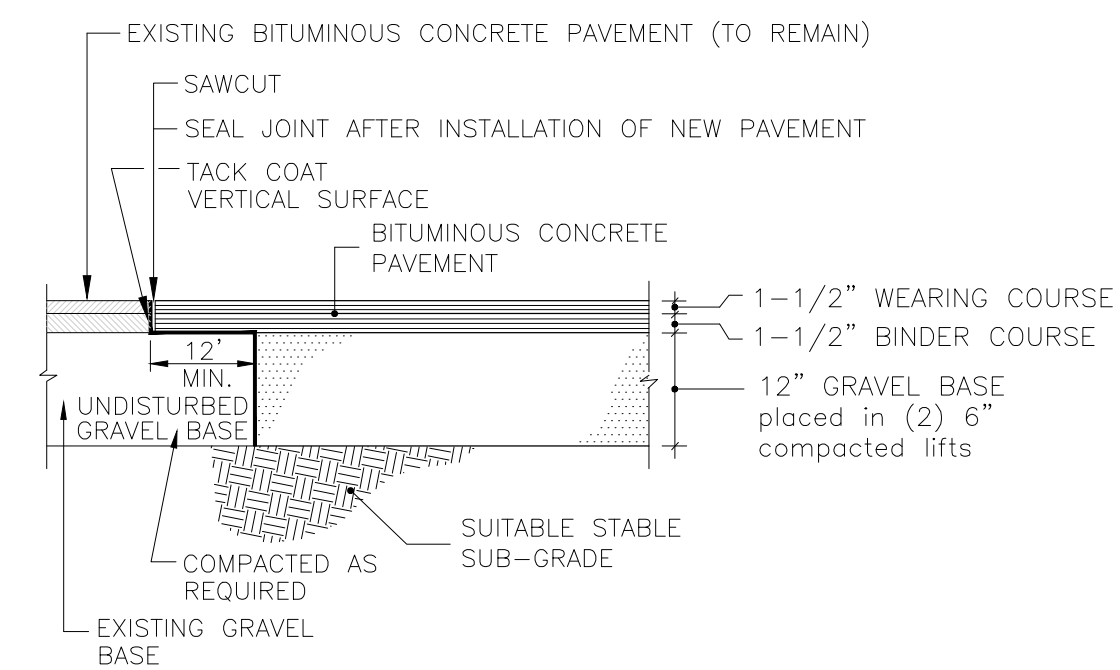

### BITUMINOUS CONCRETE PAVEMENT SECTION

NOT TO SCALE

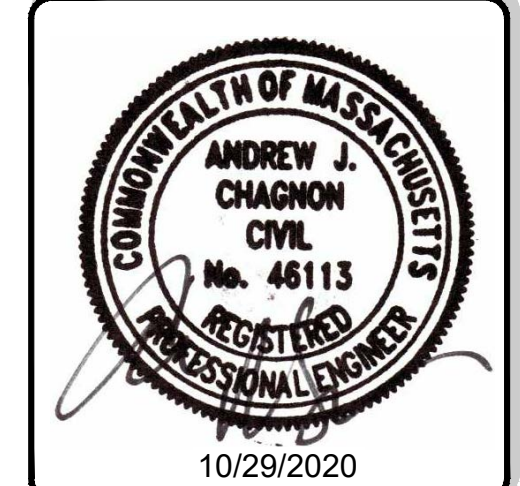

10/29/2020

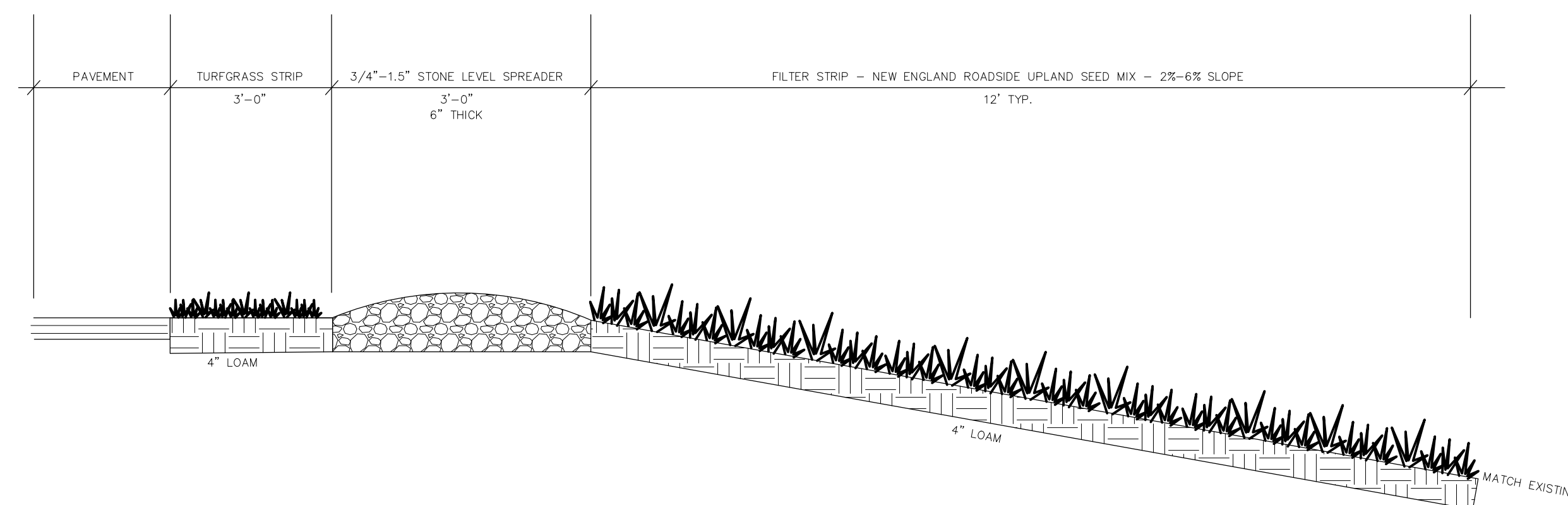

### VEGETATED FILTER STRIP SECTION

NOT TO SCALE

### SITE DETAILS

SITE: 1047 WASHINGTON STREET /  
0 WASHINGTON STREET  
WEYMOUTH, MASSACHUSETTS 02189

FOR: JOE GRATTA  
1047 WASHINGTON STREET  
WEYMOUTH, MASSACHUSETTS 02189

NO.	REVISIONS
1	10/29/2020 - CONCOM
2	
3	
4	
5	
6	
7	
8	
9	
10	

DATE: 10/29/2020	<b>C2.1</b>
DRAWN BY: JJA	
CHECKED BY: AJC	
JOB #: 64380	