



EDGE OF SALT MARSH

FEMA ZONE AE10 (16.6 TOWN DATUM)
FIRM PANEL 25021C0227F (6/09/2014)

N/F MASS ELECTRIC CO.
LOT 130-10

WOOD FENCE

APPROXIMATE
LOCATION

FEMA AE
LINE

LOT 130-52
7500 SF

LOT 130-51

LOT 130-53

EXISTING GARAGE
& BREEZWAY
TO BE REMOVED

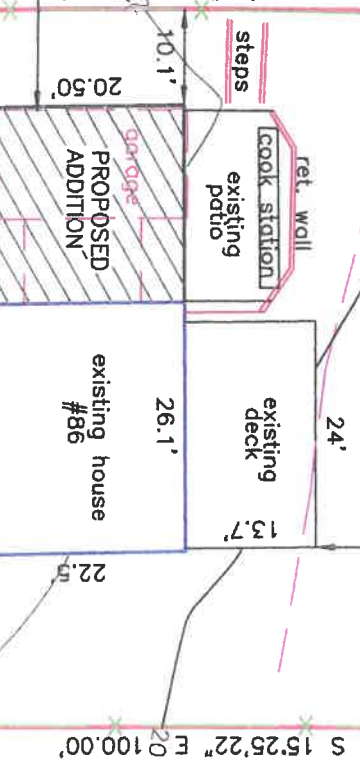

asphalt sidewalk
edge of road

ABIGAIL ADAMS CIRCLE

(PUBLIC WAY--40' WIDE)



ZONING DISTRICT: R-1

TABLE OF MINIMUM SETBACKS:	
REQUIRED	PROVIDED
AREA-25,000	AREA-7,500
WIDTH-120'	WIDTH-75'
FRONT-18'	FRONT-25.7'
REAR-24'	REAR-38.16'
SIDE-10'	SIDE-10.1'
HEIGHT-35'	HEIGHT-24'

I HEREBY CERTIFY THAT THE EXISTING
STRUCTURES SHOWN ON THIS PLAN WERE
LOCATED BY AN INSTRUMENT SURVEY AND
ARE LOCATED ON THE GROUND AS SHOWN HEREIN.

NOTES:

1. DEED: CERT #202920
2. LC PLAN 21146A
3. ELEVATION DATUM= TOWN OF WEYMOUTH



PROPOSED ADDITION

86 ABIGAIL ADAMS CIR
WEYMOUTH, MA
PARCEL ID: 13-130-52
OWNER: SCOTT BROOKS

SCALE: 1" = 20'
DATE: JUNE 30, 2021
ZONING DISTRICT: RESIDENCE 1