



September 9, 2022

Ref: 14959.00

Weymouth Conservation Commission
Weymouth Town Hall
75 Middle Street
Weymouth, MA 02189

Re: Request for Certificate of Compliance - DEP File # 081-1260
National Grid – Gas Main Installation - Greenvale Ave
Weymouth, Massachusetts

Dear Commission Members & Staff,

On behalf of the Boston Gas Company, Vanasse Hangen Brustlin, Inc. (VHB) respectfully requests that the Weymouth Conservation Commission issue a Certificate of Compliance for the Order of Conditions (OOC) issued by the Commission on November 20, 2020, under DEP File No. 081-1260, recorded at the Norfolk County Registry of Deeds Book 38798, Page 435. This request is for certification that the work regulated by the above-referenced Order of Conditions has been satisfactorily completed.

The OOC approved the installation of underground natural gas utilities within existing paved roadways in Weymouth, MA (Project). The Project utilized horizontal directional drilling methodology to avoid direct impacts to wetland resource areas in proximity to a culverted stream tributary to Whitmans Pond, and therefore did not result in any permanent impacts. Portions of the Project were located within the 100-ft Buffer Zone to wetland resource areas subject to jurisdiction under the Wetland Protection Act (WPA), as well as Riverfront Area. In addition, the Project is located within an area mapped as Outstanding Resource Water (ORW). Appropriate erosion and sedimentation controls were implemented during construction of the Project. Detailed as-built plans depicting post-construction conditions on the work site along with a statement in writing have been provided in the following attachments.

The following materials are provided to assist the Conservation Commission in reviewing this Request for Certificate of Compliance:

- MassDEP Form 8A – Request for Certificate of Compliance
- Order of Conditions (DEP File No. 081-1260) & Proof of Recording
- Gas System Operating Procedure As-Built.

Town of Weymouth – Request for Certificate of Compliance
DEP # 081-1260
September 9, 2022
Page 2



- Photography Log dated August 17, 2022

If you have any questions regarding this Request for Certificate of Compliance or require additional information for your review, please contact me at (617) 607-6156 or kkoncewicz@vhb.com.

Sincerely,

A handwritten signature in black ink, appearing to read "Kelan Koncewicz", written in a cursive style.

Kelan Koncewicz

Environmental Scientist
kkoncewicz@vhb.com

cc: Kevin O'Brion, National Grid



Massachusetts Department of Environmental Protection
 Bureau of Resource Protection - Wetlands
WPA Form 8A – Request for Certificate of Compliance
 Massachusetts Wetlands Protection Act M.G.L. c. 131, §40

DEP File Number:

81-1260
 Provided by DEP

A. Project Information

Important:
 When filling out forms on the computer, use only the tab key to move your cursor - do not use the return key.



Upon completion of the work authorized in an Order of Conditions, the property owner must request a Certificate of Compliance from the issuing authority stating that the work or portion of the work has been satisfactorily completed.

1. This request is being made by:

<u>Andrew Shelby - Boston Gas Company</u>		
Name		
<u>40 Sylvan Road</u>		
Mailing Address		
<u>Waltham</u>	<u>MA</u>	<u>02451</u>
City/Town	State	Zip Code
<u>781-907-1867</u>		
Phone Number		

2. This request is in reference to work regulated by a final Order of Conditions issued to:

<u>Andrew Shelby - Boston Gas Company</u>	
Applicant	
<u>11/20/2020</u>	<u>81-1260</u>
Dated	DEP File Number

3. The project site is located at:

<u>Greenvale Avenue</u>	<u>Weymouth</u>
Street Address	City/Town
<u>NA - Public Road ROW</u>	<u>NA - Public Road ROW</u>
Assessors Map/Plat Number	Parcel/Lot Number

4. The final Order of Conditions was recorded at the Registry of Deeds for:

<u>NA - Public Road ROW</u>		
Property Owner (if different)		
<u>Norfolk</u>	<u>38789</u>	<u>434</u>
County	Book	Page

Certificate (if registered land)

5. This request is for certification that (check one):
 - the work regulated by the above-referenced Order of Conditions has been satisfactorily completed.
 - the following portions of the work regulated by the above-referenced Order of Conditions have been satisfactorily completed (use additional paper if necessary).

 - the above-referenced Order of Conditions has lapsed and is therefore no longer valid, and the work regulated by it was never started.



A. Project Information (cont.)

6. Did the Order of Conditions for this project, or the portion of the project subject to this request, contain an approval of any plans stamped by a registered professional engineer, architect, landscape architect, or land surveyor?

Yes

If yes, attach a written statement by such a professional certifying substantial compliance with the plans and describing what deviation, if any, exists from the plans approved in the Order.

No

B. Submittal Requirements

Requests for Certificates of Compliance should be directed to the issuing authority that issued the final Order of Conditions (OOC). If the project received an OOC from the Conservation Commission, submit this request to that Commission. If the project was issued a Superseding Order of Conditions or was the subject of an Adjudicatory Hearing Final Decision, submit this request to the appropriate DEP Regional Office (see <http://www.mass.gov/eea/agencies/massdep/about/contacts/find-the-massdep-regional-office-for-your-city-or-town.html>).

Bk 38798 P434 #147775
12-28-2020 @ 02:30P

NOT
AN
OFFICIAL
COPY

NOT
AN
OFFICIAL
RECEIVED AND RECORDED
NORFOLK COUNTY
REGISTRY OF DEEDS
D&DHAM, MA

CERTIFY
William P. O'Donnell
WILLIAM P. O'DONNELL, REGISTER



Massachusetts Department of Environmental Protection
Bureau of Resource Protection - Wetlands
WPA Form 5 – Order of Conditions
Massachusetts Wetlands Protection Act M.G.L. c. 131, §40

Provided by MassDEP:
81-1260
MassDEP File #
eDEP Transaction #
Weymouth
City/Town

A. General Information

Please note:
this form has been modified with added space to accommodate the Registry of Deeds Requirements

Important:
When filling out forms on the computer, use only the tab key to move your cursor - do not use the return key.



1. From: Weymouth
Conservation Commission

2. This issuance is for (check one):
a. Order of Conditions b. Amended Order of Conditions

3. To: Applicant:

Andrew Shelby
a. First Name b. Last Name

Boston Gas Company
c. Organization

40 Sylvan Road
d. Mailing Address

Waltham MA 02451
e. City/Town f. State g. Zip Code

4. Property Owner (if different from applicant):

N/A (Roadway Right-of-Way)
a. First Name b. Last Name

c. Organization

d. Mailing Address

e. City/Town f. State g. Zip Code

5. Project Location:

Greenvale Avenue Weymouth
a. Street Address b. City/Town

NA -Public Road ROW NA -Public Road ROW
c. Assessors Map/Plat Number d. Parcel/Lot Number

Latitude and Longitude, if known: d m s d m s
d. Latitude e. Longitude

Please return to:
 Grace Walsh / Legal Dept.
National Grid Page 1 of 13
40 Sylvan Road
Waltham, MA 02451"

16

N O T N O T



Massachusetts Department of Environmental Protection
Bureau of Resource Protection - Wetlands C I A L
WPA Form 5 - Order of Conditions
Massachusetts Wetlands Protection Act M.G.L. c. 131, §40

Provided by MassDEP:
81-1260
MassDEP File #
eDEP Transaction #
Weymouth
City/Town

A. General Information (cont.)

6. Property recorded at the Registry of Deeds for (attach additional information if more than one parcel)

Norfolk

a. County _____ b. Certificate Number (if registered land) _____

c. Book _____ d. Page _____

7. Dates: 10/08/2020 10/27/2020 11/20/2020
a. Date Notice of Intent Filed b. Date Public Hearing Closed c. Date of Issuance

8. Final Approved Plans and Other Documents (attach additional plan or document references as needed):

National Grid Proposed approximately (260') 2" Plastic HDPE 60 PSIG Gas Main Installation via HDD Method (6 pgs)

CHA for National Grid Jeffrey E. O'Donnell, PE

b. Prepared By c. Signed and Stamped by

10/07/2020 1"=10'

d. Final Revision Date e. Scale

f. Additional Plan or Document Title g. Date

B. Findings

1. Findings pursuant to the Massachusetts Wetlands Protection Act:

Following the review of the above-referenced Notice of Intent and based on the information provided in this application and presented at the public hearing, this Commission finds that the areas in which work is proposed is significant to the following interests of the Wetlands Protection Act (the Act). Check all that apply:

- a. Public Water Supply
- b. Land Containing Shellfish
- c. Prevention of Pollution
- d. Private Water Supply
- e. Fisheries
- f. Protection of Wildlife Habitat
- g. Groundwater Supply
- h. Storm Damage Prevention
- i. Flood Control

2. This Commission hereby finds the project, as proposed, is: (check one of the following boxes)

Approved subject to:

- a. the following conditions which are necessary in accordance with the performance standards set forth in the wetlands regulations. This Commission orders that all work shall be performed in accordance with the Notice of Intent referenced above, the following General Conditions, and any other special conditions attached to this Order. To the extent that the following conditions modify or differ from the plans, specifications, or other proposals submitted with the Notice of Intent, these conditions shall control.

N O T N O T



Massachusetts Department of Environmental Protection
 Bureau of Resource Protection - Wetlands C I A L
WPA Form 5 - Order of Conditions
 Massachusetts Wetlands Protection Act M.G.L. c. 131, §40

Provided by MassDEP:
 81-1260
 MassDEP File # _____

eDEP Transaction # _____
Weymouth
 City/Town

B. Findings (cont.)

Denied because:

- b. the proposed work cannot be conditioned to meet the performance standards set forth in the wetland regulations. Therefore, work on this project may not go forward unless and until a new Notice of Intent is submitted which provides measures which are adequate to protect the interests of the Act, and a final Order of Conditions is issued. **A description of the performance standards which the proposed work cannot meet is attached to this Order.**
- c. the information submitted by the applicant is not sufficient to describe the site, the work, or the effect of the work on the interests identified in the Wetlands Protection Act. Therefore, work on this project may not go forward unless and until a revised Notice of Intent is submitted which provides sufficient information and includes measures which are adequate to protect the Act's interests, and a final Order of Conditions is issued. **A description of the specific information which is lacking and why it is necessary is attached to this Order as per 310 CMR 10.05(6)(c).**
- 3. Buffer Zone Impacts: Shortest distance between limit of project disturbance and the wetland resource area specified in 310 CMR 10.02(1)(a) _____ a. linear feet

Inland Resource Area Impacts: Check all that apply below. (For Approvals Only)

Resource Area	Proposed Alteration	Permitted Alteration	Proposed Replacement	Permitted Replacement
4. <input type="checkbox"/> Bank	_____ a. linear feet	_____ b. linear feet	_____ c. linear feet	_____ d. linear feet
5. <input type="checkbox"/> Bordering Vegetated Wetland	_____ a. square feet	_____ b. square feet	_____ c. square feet	_____ d. square feet
6. <input type="checkbox"/> Land Under Waterbodies and Waterways	_____ a. square feet	_____ b. square feet	_____ c. square feet	_____ d. square feet
	_____ e. c/y dredged	_____ f. c/y dredged		
7. <input type="checkbox"/> Bordering Land Subject to Flooding	_____ a. square feet	_____ b. square feet	_____ c. square feet	_____ d. square feet
Cubic Feet Flood Storage	_____ e. cubic feet	_____ f. cubic feet	_____ g. cubic feet	_____ h. cubic feet
8. <input type="checkbox"/> Isolated Land Subject to Flooding	_____ a. square feet	_____ b. square feet		
Cubic Feet Flood Storage	_____ c. cubic feet	_____ d. cubic feet	_____ e. cubic feet	_____ f. cubic feet
9. <input checked="" type="checkbox"/> Riverfront Area	50 (temp) _____ a. total sq. feet	50 (temp) _____ b. total sq. feet		
Sq ft within 100 ft	50 (temp) _____ c. square feet	50 (temp) _____ d. square feet	_____ e. square feet	_____ f. square feet
Sq ft between 100-200 ft	_____ g. square feet	_____ h. square feet	_____ i. square feet	_____ j. square feet

N O T

N O T



Massachusetts Department of Environmental Protection
Bureau of Resource Protection - Wetlands

WPA Form 5 - Order of Conditions
 Massachusetts Wetlands Protection Act M.G.L. c. 131, §40

Provided by MassDEP:
 81-1260

MassDEP File # _____

eDEP Transaction # _____

Weymouth
 City/Town

B. Findings (cont.)

Coastal Resource Area Impacts: Check all that apply below. (For Approvals Only)

	Proposed Alteration	Permitted Alteration	Proposed Replacement	Permitted Replacement
10. <input type="checkbox"/> Designated Port Areas	Indicate size under Land Under the Ocean, below			
11. <input type="checkbox"/> Land Under the Ocean	_____	_____		
	a. square feet	b. square feet		
	_____	_____		
	c. c/y dredged	d. c/y dredged		
12. <input type="checkbox"/> Barrier Beaches	Indicate size under Coastal Beaches and/or Coastal Dunes below			
13. <input type="checkbox"/> Coastal Beaches	_____	_____	_____ cu yd	_____ cu yd
	a. square feet	b. square feet	c. nourishment	d. nourishment
14. <input type="checkbox"/> Coastal Dunes	_____	_____	_____ cu yd	_____ cu yd
	a. square feet	b. square feet	c. nourishment	d. nourishment
15. <input type="checkbox"/> Coastal Banks	_____	_____		
	a. linear feet	b. linear feet		
16. <input type="checkbox"/> Rocky Intertidal Shores	_____	_____		
	a. square feet	b. square feet		
17. <input type="checkbox"/> Salt Marshes	_____	_____	_____	_____
	a. square feet	b. square feet	c. square feet	d. square feet
18. <input type="checkbox"/> Land Under Salt Ponds	_____	_____		
	a. square feet	b. square feet		
	_____	_____		
	c. c/y dredged	d. c/y dredged		
19. <input type="checkbox"/> Land Containing Shellfish	_____	_____	_____	_____
	a. square feet	b. square feet	c. square feet	d. square feet
20. <input type="checkbox"/> Fish Runs	Indicate size under Coastal Banks, Inland Bank, Land Under the Ocean, and/or inland Land Under Waterbodies and Waterways, above			
	_____	_____		
	a. c/y dredged	b. c/y dredged		
21. <input type="checkbox"/> Land Subject to Coastal Storm Flowage	_____	_____		
	a. square feet	b. square feet		
22. <input type="checkbox"/> Riverfront Area	_____	_____		
	a. total sq. feet	b. total sq. feet		
Sq ft within 100 ft	_____	_____	_____	_____
	c. square feet	d. square feet	e. square feet	f. square feet
Sq ft between 100-200 ft	_____	_____	_____	_____
	g. square feet	h. square feet	i. square feet	j. square feet

N O T N O T



Massachusetts Department of Environmental Protection
Bureau of Resource Protection - Wetlands C I A L
WPA Form 5 – Order of Conditions
Massachusetts Wetlands Protection Act M.G.L. c. 131, §40

Provided by MassDEP:
81-1260
MassDEP File #
eDEP Transaction #
Weymouth
City/Town

B. Findings (cont.)

* #23. If the project is for the purpose of restoring or enhancing a wetland resource area in addition to the square footage that has been entered in Section B.5.c (BWV) or B.17.c (Salt Marsh) above, please enter the additional amount here.

23. Restoration/Enhancement *:

a. square feet of BWV

b. square feet of salt marsh

24. Stream Crossing(s):

a. number of new stream crossings

b. number of replacement stream crossings

C. General Conditions Under Massachusetts Wetlands Protection Act

The following conditions are only applicable to Approved projects.

1. Failure to comply with all conditions stated herein, and with all related statutes and other regulatory measures, shall be deemed cause to revoke or modify this Order.
2. The Order does not grant any property rights or any exclusive privileges; it does not authorize any injury to private property or invasion of private rights.
3. This Order does not relieve the permittee or any other person of the necessity of complying with all other applicable federal, state, or local statutes, ordinances, bylaws, or regulations.
4. The work authorized hereunder shall be completed within three years from the date of this Order unless either of the following apply:
 - a. The work is a maintenance dredging project as provided for in the Act; or
 - b. The time for completion has been extended to a specified date more than three years, but less than five years, from the date of issuance. If this Order is intended to be valid for more than three years, the extension date and the special circumstances warranting the extended time period are set forth as a special condition in this Order.
 - c. If the work is for a Test Project, this Order of Conditions shall be valid for no more than one year.
5. This Order may be extended by the issuing authority for one or more periods of up to three years each upon application to the issuing authority at least 30 days prior to the expiration date of the Order. An Order of Conditions for a Test Project may be extended for one additional year only upon written application by the applicant, subject to the provisions of 310 CMR 10.05(11)(f).
6. If this Order constitutes an Amended Order of Conditions, this Amended Order of Conditions does not extend the issuance date of the original Final Order of Conditions and the Order will expire on _____ unless extended in writing by the Department.
7. Any fill used in connection with this project shall be clean fill. Any fill shall contain no trash, refuse, rubbish, or debris, including but not limited to lumber, bricks, plaster, wire, lath, paper, cardboard, pipe, tires, ashes, refrigerators, motor vehicles, or parts of any of the foregoing.

N O T N O T



Massachusetts Department of Environmental Protection
Bureau of Resource Protection - Wetlands C I A L
WPA Form 5 – Order of Conditions
Massachusetts Wetlands Protection Act M.G.L. c. 131, §40

Provided by MassDEP:
81-1260
MassDEP File #
eDEP Transaction #
Weymouth
City/Town

C. General Conditions Under Massachusetts Wetlands Protection Act

- 8. This Order is not final until all administrative appeal periods from this Order have elapsed, or if such an appeal has been taken, until all proceedings before the Department have been completed.
- 9. No work shall be undertaken until the Order has become final and then has been recorded in the Registry of Deeds or the Land Court for the district in which the land is located, within the chain of title of the affected property. In the case of recorded land, the Final Order shall also be noted in the Registry's Grantor Index under the name of the owner of the land upon which the proposed work is to be done. In the case of the registered land, the Final Order shall also be noted on the Land Court Certificate of Title of the owner of the land upon which the proposed work is done. The recording information shall be submitted to the Conservation Commission on the form at the end of this Order, which form must be stamped by the Registry of Deeds, prior to the commencement of work.
- 10. A sign shall be displayed at the site not less than two square feet or more than three square feet in size bearing the words,

"Massachusetts Department of Environmental Protection" [or, "MassDEP"]
"File Number 81-1260 "
- 11. Where the Department of Environmental Protection is requested to issue a Superseding Order, the Conservation Commission shall be a party to all agency proceedings and hearings before MassDEP.
- 12. Upon completion of the work described herein, the applicant shall submit a Request for Certificate of Compliance (WPA Form 8A) to the Conservation Commission.
- 13. The work shall conform to the plans and special conditions referenced in this order.
- 14. Any change to the plans identified in Condition #13 above shall require the applicant to inquire of the Conservation Commission in writing whether the change is significant enough to require the filing of a new Notice of Intent.
- 15. The Agent or members of the Conservation Commission and the Department of Environmental Protection shall have the right to enter and inspect the area subject to this Order at reasonable hours to evaluate compliance with the conditions stated in this Order, and may require the submittal of any data deemed necessary by the Conservation Commission or Department for that evaluation.
- 16. This Order of Conditions shall apply to any successor in interest or successor in control of the property subject to this Order and to any contractor or other person performing work conditioned by this Order.

N O T N O T



Massachusetts Department of Environmental Protection
Bureau of Resource Protection - Wetlands
WPA Form 5 - Order of Conditions
Massachusetts Wetlands Protection Act M.G.L. c. 131, §40

Provided by MassDEP:
81-1260
MassDEP File #
eDEP Transaction #
Weymouth
City/Town

C. General Conditions Under Massachusetts Wetlands Protection Act (cont.)

- 17. Prior to the start of work, and if the project involves work adjacent to a Bordering Vegetated Wetland, the boundary of the wetland in the vicinity of the proposed work area shall be marked by wooden stakes or flagging. Once in place, the wetland boundary markers shall be maintained until a Certificate of Compliance has been issued by the Conservation Commission.
- 18. All sedimentation barriers shall be maintained in good repair until all disturbed areas have been fully stabilized with vegetation or other means. At no time shall sediments be deposited in a wetland or water body. During construction, the applicant or his/her designee shall inspect the erosion controls on a daily basis and shall remove accumulated sediments as needed. The applicant shall immediately control any erosion problems that occur at the site and shall also immediately notify the Conservation Commission, which reserves the right to require additional erosion and/or damage prevention controls it may deem necessary. Sedimentation barriers shall serve as the limit of work unless another limit of work line has been approved by this Order.
- 19. The work associated with this Order (the "Project")
 - (1) is subject to the Massachusetts Stormwater Standards
 - (2) is NOT subject to the Massachusetts Stormwater Standards

If the work is subject to the Stormwater Standards, then the project is subject to the following conditions:

- a) All work, including site preparation, land disturbance, construction and redevelopment, shall be implemented in accordance with the construction period pollution prevention and erosion and sedimentation control plan and, if applicable, the Stormwater Pollution Prevention Plan required by the National Pollution Discharge Elimination System Construction General Permit as required by Stormwater Condition 8. Construction period erosion, sedimentation and pollution control measures and best management practices (BMPs) shall remain in place until the site is fully stabilized.
- b) No stormwater runoff may be discharged to the post-construction stormwater BMPs unless and until a Registered Professional Engineer provides a Certification that:
 - i. all construction period BMPs have been removed or will be removed by a date certain specified in the Certification. For any construction period BMPs intended to be converted to post construction operation for stormwater attenuation, recharge, and/or treatment, the conversion is allowed by the MassDEP Stormwater Handbook BMP specifications and that the BMP has been properly cleaned or prepared for post construction operation, including removal of all construction period sediment trapped in inlet and outlet control structures;
 - ii. as-built final construction BMP plans are included, signed and stamped by a Registered Professional Engineer, certifying the site is fully stabilized;
 - iii. any illicit discharges to the stormwater management system have been removed, as per the requirements of Stormwater Standard 10;

N O T

N O T



Massachusetts Department of Environmental Protection
Bureau of Resource Protection - Wetlands
WPA Form 5 - Order of Conditions
 Massachusetts Wetlands Protection Act M.G.L. c. 131, §40

Provided by MassDEP:
 81-1260
 MassDEP File #

eDEP Transaction #
 Weymouth
 City/Town

C. General Conditions Under Massachusetts Wetlands Protection Act (cont.)

- iv. all post-construction stormwater BMPs are installed in accordance with the plans (including all planting plans) approved by the issuing authority, and have been inspected to ensure that they are not damaged and that they are in proper working condition;
- v. any vegetation associated with post-construction BMPs is suitably established to withstand erosion.
- c) The landowner is responsible for BMP maintenance until the issuing authority is notified that another party has legally assumed responsibility for BMP maintenance. Prior to requesting a Certificate of Compliance, or Partial Certificate of Compliance, the responsible party (defined in General Condition 18(e)) shall execute and submit to the issuing authority an Operation and Maintenance Compliance Statement ("O&M Statement") for the Stormwater BMPs identifying the party responsible for implementing the stormwater BMP Operation and Maintenance Plan ("O&M Plan") and certifying the following:
- i.) the O&M Plan is complete and will be implemented upon receipt of the Certificate of Compliance, and
 - ii.) the future responsible parties shall be notified in writing of their ongoing legal responsibility to operate and maintain the stormwater management BMPs and implement the Stormwater Pollution Prevention Plan.
- d) Post-construction pollution prevention and source control shall be implemented in accordance with the long-term pollution prevention plan section of the approved Stormwater Report and, if applicable, the Stormwater Pollution Prevention Plan required by the National Pollution Discharge Elimination System Multi-Sector General Permit.
- e) Unless and until another party accepts responsibility, the landowner, or owner of any drainage easement, assumes responsibility for maintaining each BMP. To overcome this presumption, the landowner of the property must submit to the issuing authority a legally binding agreement of record, acceptable to the issuing authority, evidencing that another entity has accepted responsibility for maintaining the BMP, and that the proposed responsible party shall be treated as a permittee for purposes of implementing the requirements of Conditions 18(f) through 18(k) with respect to that BMP. Any failure of the proposed responsible party to implement the requirements of Conditions 18(f) through 18(k) with respect to that BMP shall be a violation of the Order of Conditions or Certificate of Compliance. In the case of stormwater BMPs that are serving more than one lot, the legally binding agreement shall also identify the lots that will be serviced by the stormwater BMPs. A plan and easement deed that grants the responsible party access to perform the required operation and maintenance must be submitted along with the legally binding agreement.
- f) The responsible party shall operate and maintain all stormwater BMPs in accordance with the design plans, the O&M Plan, and the requirements of the Massachusetts Stormwater Handbook.

N O T

N O T



Massachusetts Department of Environmental Protection
Bureau of Resource Protection - Wetlands
WPA Form 5 - Order of Conditions
Massachusetts Wetlands Protection Act M.G.L. c. 131, §40

Provided by MassDEP:
81-1260
MassDEP File #
eDEP Transaction #
Weymouth
City/Town

C. General Conditions Under Massachusetts Wetlands Protection Act (cont.)

- g) The responsible party shall:
 1. Maintain an operation and maintenance log for the last three (3) consecutive calendar years of inspections, repairs, maintenance and/or replacement of the stormwater management system or any part thereof, and disposal (for disposal the log shall indicate the type of material and the disposal location);
 2. Make the maintenance log available to MassDEP and the Conservation Commission ("Commission") upon request; and
 3. Allow members and agents of the MassDEP and the Commission to enter and inspect the site to evaluate and ensure that the responsible party is in compliance with the requirements for each BMP established in the O&M Plan approved by the issuing authority.
- h) All sediment or other contaminants removed from stormwater BMPs shall be disposed of in accordance with all applicable federal, state, and local laws and regulations.
- i) Illicit discharges to the stormwater management system as defined in 310 CMR 10.04 are prohibited.
- j) The stormwater management system approved in the Order of Conditions shall not be changed without the prior written approval of the issuing authority.
- k) Areas designated as qualifying pervious areas for the purpose of the Low Impact Site Design Credit (as defined in the MassDEP Stormwater Handbook, Volume 3, Chapter 1, Low Impact Development Site Design Credits) shall not be altered without the prior written approval of the issuing authority.
- l) Access for maintenance, repair, and/or replacement of BMPs shall not be withheld. Any fencing constructed around stormwater BMPs shall include access gates and shall be at least six inches above grade to allow for wildlife passage.

Special Conditions (if you need more space for additional conditions, please attach a text document):

Condition #s 22 - #43

- 20. For Test Projects subject to 310 CMR 10.05(11), the applicant shall also implement the monitoring plan and the restoration plan submitted with the Notice of Intent. If the conservation commission or Department determines that the Test Project threatens the public health, safety or the environment, the applicant shall implement the removal plan submitted with the Notice of Intent or modify the project as directed by the conservation commission or the Department.

N O T N O T



Massachusetts Department of Environmental Protection
Bureau of Resource Protection - Wetlands
WPA Form 5 - Order of Conditions
Massachusetts Wetlands Protection Act M.G.L. c. 131, §40

Provided by MassDEP:
81-1260
MassDEP File #
eDEP Transaction #
Weymouth
City/Town

D. Findings Under Municipal Wetlands Bylaw or Ordinance

- 1. Is a municipal wetlands bylaw or ordinance applicable? Yes No
- 2. The Weymouth hereby finds (check one that applies):
Conservation Commission
 - a. that the proposed work cannot be conditioned to meet the standards set forth in a municipal ordinance or bylaw, specifically:

1. Municipal Ordinance or Bylaw	2. Citation
---------------------------------	-------------

Therefore, work on this project may not go forward unless and until a revised Notice of Intent is submitted which provides measures which are adequate to meet these standards, and a final Order of Conditions is issued.

- b. that the following additional conditions are necessary to comply with a municipal ordinance or bylaw:
Town of Weymouth Code of Ordinances, Chapter 7, Section 301

1. Municipal Ordinance or Bylaw	2. Citation
---------------------------------	-------------

- 3. The Commission orders that all work shall be performed in accordance with the following conditions and with the Notice of Intent referenced above. To the extent that the following conditions modify or differ from the plans, specifications, or other proposals submitted with the Notice of Intent, the conditions shall control.
The special conditions relating to municipal ordinance or bylaw are as follows (if you need more space for additional conditions, attach a text document):

condition #s 21 - #43

APPLICANT: Boston Gas Company
LOCATION: Greenvale Avenue, Weymouth
DEP FILE #: N O T
81-1260 N O T
A N A N

O F F I C I A L O F F I C I A L

General Conditions O P Y C O P Y

- 21. The Commission's actions on this project are taken under the Weymouth Code of Ordinances Chapter 7, subject to compliance with the conditions and limitations imposed herein, and any work authorized hereafter shall be completed within three (3) years from the date of issuance of this Order. Any request for extension of this Order shall be made, in writing, not less than thirty (30) days before the expiration of this Order. An appeal of an Order issued under Weymouth Code of Ordinances Chapter 7, Section 301 may be taken in Superior Court.
- 22. No work may begin until the Commission has received certification from the Registry of Deeds or the Land Court or both, as appropriate, that this Order has been recorded in the line of title of the property. The Order shall be recorded in the line of title of the subject property (Map 33, Block 433, Lot 4) and the adjacent property which contains the drainage easement (Map 34, Block 433, Lot 16).
- 23. A copy of this Order shall be kept on the work site at all times during construction. The applicant is responsible for providing a copy to all contractors and subcontractors, for informing them of its requirements, and for assuring that they comply with those.
- 24. These Conditions are intended solely as a permit to perform work within areas of the Commission's jurisdiction, and nothing contained herein shall be construed as pre-empting or precluding any other bylaw, ordinance or local regulation.
- 25. Members and agents of the Commission have the right to enter and inspect the property, as per M.G.L. Ch. 131, §40, and Weymouth Town Code of Ordinances, Chapter 7, in order to evaluate and enforce compliance with this Order. The applicant shall submit data or information that the Commission deems necessary for that evaluation.
- 26. This Order shall apply to all successors in interest, successors in control, and successors in title. This Condition shall remain in perpetuity and shall not expire with the issuance of the Certificate of Compliance.
- 27. Before making any change in the project as designed and specified in the plans listed above, the applicant shall inquire of the Commission, in writing, whether the change is so substantial as to require the filing of a new Notice, may be permitted as an amendment to this Order, or may be carried out under these Conditions as issued.

APPLICANT: Boston Gas Company
LOCATION: N O T
DEP FILE #: 81-1260
A N A N

O F F I C I A L O F F I C I A L

28. The Commission reserves the right to impose additional conditions or require the submission of additional information as necessary to protect the interests of the State and Local Wetland Protection Act.

Pre-Construction Conditions

29. All required local, state and federal permits shall be obtained before construction begins.

30. Prior to the start of work, the applicant shall provide the Commission with the name(s), address(es) and telephone number(s) of the person(s) responsible for ensuring on-site compliance with this Order and his or her alternate. This person shall be the Environmental Monitor for the project and shall be given authority to stop construction for erosion control or other environmental purposes.

31. The Conservation Commission shall be notified 48 hours prior to any work on this site.

32. Prior to construction or excavation, an erosion control barrier, consisting of a line of 12-inch SiltSoxx™ or equivalent, or other controls approved by the Administrator, shall be installed as shown on the approved plans. Catch basins within the area shall be fitted with "silt sack" devices.

33. After installation of the erosion control measures, and prior to any other work, **the applicant and/or the project manager shall meet on the site with the Conservation Administrator to review the placement of the protection and the Order of Conditions issued for this project.**

Construction-Related Conditions

34. An adequate stockpile of erosion control materials shall be on site at all times for emergency or routine replacement.

35. Erosion and sediment control measures, including perimeter controls and silt sacks shall be routinely inspected, maintained and replaced as needed to ensure their proper functioning for the duration of the project. Workers at the site shall be told of the purpose of the erosion control measures and instructed to protect them from damage by tools or machinery. Catch basins shall be cleaned at the conclusion of the job if so required by the Conservation Commission or Department of Public Works. Erosion control barriers shall be removed after work is completed on all portions of the project and all bare ground has been stabilized.

APPLICANT: Boston Gas Company
LOCATION: N O T
DEP FILE #: 81-1260
A N A N

O F F I C I A L O F F I C I A L

- 36. Horizontal directional drilling shall follow the protocol and procedures as documented in the Notice of Intent and HDD Contingency Plan (Attachment C of the NOI). Sediment control measures shall be installed around "sending" and "receiving" ports. As discussed in the public hearing, an Environmental Monitor shall oversee the HDD process, and drilling fluids and soil cuttings shall be removed using a vacuum truck which shall be staged on-site for this purpose.
- 37. The HDD operation shall be performed in a manner to prevent the discharge of drilling fluids and cuttings to nearby wetlands and waterways. If an inadvertent return or "frac out" of drilling fluids occurs during this project, the Conservation Office shall be notified immediately (781-340-5007) and measures shall be taken as contained in the HDD Contingency Plan.
- 38. Piles of trench spoils or fill, if any, shall be properly protected by erosion controls and tarps, and shall be located outside of the Riverfront Area to the extent possible. All piles shall be completely secured at the end of each work day.
- 39. All active trenches shall be closed at the end of each work day.
- 40. If dewatering is necessary during construction, dewatering shall be conducted in a manner that prevents discharge of turbid water to wetland resource areas. Excess water shall be pumped to a filter bag, lined haybale corral, sedimentation basin and/or sedimentation tank, or other method approved by the Conservation Commission, located in an upland area at least 50 feet from a wetland edge or riverfront area.
- 41. If unforeseen problems occur during construction which may affect the statutory interest of the Wetlands Protection Act or the Town of Weymouth's Wetlands Protection Ordinance, upon discovery by either the Conservation Commission, its agent, or the applicant, the Commission shall immediately be notified, and an immediate meeting shall be held between the Commission or its agent, the applicant, and other concerned parties to determine the correct measures to be employed. The applicant shall then act to correct the problems using the corrective measures agreed upon. Subsequent to resolution, the activity and resulting actions shall be documented in writing.
- 42. To the extent possible, servicing of equipment (including, but not limited to, fueling, changing, adding or applying lubricants or hydraulic fluids) shall be done in excess of one hundred (100) feet distance from the delineated resource areas as shown on the plans referenced herein. Such equipment must be maintained to prevent leakage or discharge of pollutants. Overnight storage of equipment must be a minimum of one hundred (100) feet from such delineated resource areas.



Massachusetts Department of Environmental Protection
Bureau of Resource Protection - Wetlands
WPA Form 5 - Order of Conditions
Massachusetts Wetlands Protection Act M.G.L. c. 131, §40

Provided by MassDEP:
81-1260
MassDEP File #
eDEP Transaction #
Weymouth
City/Town

E. Signatures

This Order is valid for three years, unless otherwise specified as a special condition pursuant to General Conditions #4, from the date of issuance.

11/20/2020

Please indicate the number of members who will sign this form.

1. Date of Issuance
3

This Order must be signed by a majority of the Conservation Commission.

2. Number of Signers

The Order must be mailed by certified mail (return receipt requested) or hand delivered to the applicant. A copy also must be mailed or hand delivered at the same time to the appropriate Department of Environmental Protection Regional Office, if not filing electronically, and the property owner, if different from applicant.

Thomas E Tanner
Signature

Thomas Tanner
Printed Name

Signature

John Reilly
Printed Name

Signature

Scott Dowd
Printed Name

Signature

George Loring
Printed Name

Signature

Frank Singleton
Printed Name

Signature

Paul A. [unclear]
Printed Name

Signature

Printed Name

Signature

Printed Name

by hand delivery on

by certified mail, return receipt requested, on

Date

11/20/2020
Date

APPLICANT: Boston Gas Company
LOCATION: N O T
Greenvale Avenue, Weymouth N O T
DEP FILE #: A N
81-1260 A N

O F F I C I A L

O F F I C I A L

Post-Construction Conditions

C O P Y

- 43. Upon completion of the project, or any discrete phase thereof, the applicant may request a Partial or Final Certificate of Compliance. The applicant must obtain a Certificate of Compliance before the building is occupied, and all Conditions in the Order must be complied with prior to the issuance of a Final Certificate of Compliance. The request shall be accompanied by the following items:
 - a. A written statement by a professional engineer or land surveyor registered in the Commonwealth of Massachusetts certifying compliance with the Notice of Intent, the approved plans, and this Order of Conditions and setting forth what deviations exist, if any;
 - b. An as-built plan shall be provided to the Commission if one is prepared for the project.
 - c. The appropriate local filing fee.

[End of special conditions]

N O T N O T



Massachusetts Department of Environmental Protection
Bureau of Resource Protection - Wetlands
WPA Form 5 – Order of Conditions
Massachusetts Wetlands Protection Act M.G.L. c. 131, §40

Provided by MassDEP:
81-1260
MassDEP File #

eDEP Transaction #
Weymouth
City/Town

F. Appeals

The applicant, the owner, any person aggrieved by this Order, any owner of land abutting the land subject to this Order, or any ten residents of the city or town in which such land is located, are hereby notified of their right to request the appropriate MassDEP Regional Office to issue a Superseding Order of Conditions. The request must be made by certified mail or hand delivery to the Department, with the appropriate filing fee and a completed Request for Departmental Action Fee Transmittal Form, as provided in 310 CMR 10.03(7) within ten business days from the date of issuance of this Order. A copy of the request shall at the same time be sent by certified mail or hand delivery to the Conservation Commission and to the applicant, if he/she is not the appellant.

Any appellants seeking to appeal the Department's Superseding Order associated with this appeal will be required to demonstrate prior participation in the review of this project. Previous participation in the permit proceeding means the submission of written information to the Conservation Commission prior to the close of the public hearing, requesting a Superseding Order, or providing written information to the Department prior to issuance of a Superseding Order.

The request shall state clearly and concisely the objections to the Order which is being appealed and how the Order does not contribute to the protection of the interests identified in the Massachusetts Wetlands Protection Act (M.G.L. c. 131, § 40), and is inconsistent with the wetlands regulations (310 CMR 10.00). To the extent that the Order is based on a municipal ordinance or bylaw, and not on the Massachusetts Wetlands Protection Act or regulations, the Department has no appellate jurisdiction.

Location: 97 Greenvale Av

City/Town: Weymouth

Parent Work Order Number: 1274766

SOP #: _____

Program: BRIDGES

Performing Organization: _____

1.5" Main Replacement on Greenvale Ave, WEY.
The project consists of a 1.5" main replacement with 260 ft of 2" HDPE 60# on Greenvale Ave, Weymouth under the culvert.

For Checklist instructions, refer to *Processing Gas Main Work Packages Procedure - GEN 03002*
Use Dropdown as either "Yes" for action completed/form included in package or "N/A"

PRE-CONSTRUCTION

- YES Oper. Pressure: 60 psig
 - YES Design Drawings
 - YES Maps - Sectionals, Etc
 - N/A Main Notes
 - YES Service Cards and SPIE
 - YES Customer Record Information
 - YES Environmental Checklist
 - YES Environmental Review Required
 - N/A Corrosion Design
 - N/A Third Party Plans
 - YES Cost Estimate
 - YES DOA Approved
 - YES Project Scope Form (complex proj)
 - N/A Executed Easement (Copy)
 - N/A Permit Application Processed
 - YES PE Stamp Received (NE)
 - N/A PSSR will be required
- Other: _____

Work Order Package Prepared:
Joe Leahy 12/15/2021
Preparer Date

Work Package Reviewed:
Jenny Lee 12/22/21
Resource Planning Rep Date

- YES / NA PCB Wipe Sample Required
- YES / NA Maps - Latest Revision
- YES / NA Community Outreach Notification
- YES / NA Valid Permit
- YES / NA Approved SOP

Work Package Ready for Installation:
4/1/22
Performing Organization Date

POST-CONSTRUCTION

- YES / NA Completed SOP
 - YES / NA Historical / Main Field Record
 - YES / NA Pressure Test Procedures
 - YES / NA Permit
 - YES / NA Restoration Submitted
 - YES / NA CPR / Service Cards
 - YES / NA Field Ticket / Contractor Daily
 - YES / NA Valve Ticket
 - YES / NA PCB Chain of Custody Form
 - YES / NA NDE Reports
 - YES / NA Coal Tar Wrap Removal Record
 - YES / NA Mapping Correction Form
 - YES / NA Service Transfer Log (DSNY)
 - YES / NA Change Control Form
 - YES / NA Uprate Checklist
 - YES / NA Street Main Data Card (USNY)
 - YES / NA Variance Analysis (Mass)
 - YES / NA Corrosion Design Installed
 - YES / NA Test Station Drawings
 - YES / NA PSSR Completed
- Other: _____

Total Footage Installed 190
Total Footage Retired 190

Historical Information Received
[Signature] 7/22/22
Performing Organization Date

Completed Work Package Checked
[Signature] 7/25/22
Resource Planning Rep Date

Work Order Package Closed
Maps and Records Rep/ _____ Date
Engineering (NYC)

See 1308825 for 40 scale

GAS SYSTEM OPERATING PROCEDURE

SOP #:	MMA2202459	Rev #:	2	Date of SOP Request:	06/02/2022
---------------	------------	---------------	---	-----------------------------	------------

REQUESTOR INFO: MMA2202459 REV #: 2

Employee #:	72013723	Employee Name:	Christian Troy	Phone #:	9782707104
Division/Business Area:	Gas Contractor Oversight NE Central			Location:	Braintree 5110

SOP DETAILS: MMA2202459 REV #: 2

SOP Last Status:	Completed 07/08/2022				
Est Start Date:	6/7/2022 12:00:00 AM	Work Order #:	1308825	Town/Boro:	WEY - WEYMOUTH
Onyx #:		ID/Grid #:	Grid	Public Works #:	
On Street:	Greenvale Ave	Cross Street 1:	Greenwood Ave	Cross Street 2:	
Field Area:	PCS	Job Type:	MISCELLANEOUS	Sect. District valve req'd:	N
I & R Rev Req'd:	N	Gas Plan/Ops Eng Rev Req'd:	Y	PCB Wipe Rev Req'd:	N
Nature Of Work:	MAIN REPLACEMENT	System Pressure:	60	Valve Tags Req'd:	Y
Basic Job Description Install 1040 Ft 2"PLI by open trench and 500 ft of 2" PL via HDD, 1 connection 25 customer service accounts 1540 ft 1.5" BS abandoned				*Critical Main N	
W/N 200" of Critical Facility:	NONE				If Other Please Describe:
Call In Date:	Call In Time:	Contact:		Phone:	
Valve(s) Involved		Regulator(s) Involved		Estimated # of customers affected: 25	
# of main connections: 1					

Gas Accountability: MMA2202459 REV #: 2

Gas Accountability Length of Pipe (ft): 1540 Initial Gas Pressure (psig): 60 Initial Gas Temperature (F): 40
 Internal Pipe Diameter (in): 1.1 Final Gas Pressure (psig): 0 Final Gas Temperature: 40
 Recovery: N MCF Line Pack: 0.043

Review Comments: MMA2202459 REV #: 2

Engineering Analyzed	By: Maxwell Fan	Phone: 781-996-8021	Date: 06/06/2022
Temperature: 45F	Jumper Sizing: n/a		
Comments: Gas Operations Engineering recommendations for average daily temperature deg 45 F (20 HDD) and warmer: 1. No bypass is required. 2. The 60# system in Greenvale Ave is a single feed. 3. Scope of work involves a main replacement. 4. Maintain a minimum pressure of 51 PSIG at all 60# locations. 5. Please note this SOP was reviewed with no other work (or gas interruption) in the nearby area. Please check with Gas Control to confirm. 6. Synergi model has been reviewed to ensure that it reflects the latest main information found in the GIS for the nearby area. 7. Contact Gas Control for approval prior to starting work.			
Instrumentation and Regulations	By:	Phone:	Date:
Comments:			
Gas Control Approved	By: Paul Mulvey	Phone: 508-421-7573	Date: 06/15/2022

STEPS NEED TO BE TAKEN: MMA2202459 REV # : 2

Minimum Operating Pressure: 51 PSIG Temperature: 45F Min Pres/Temp Last Updated: 06/06/2022 10:42 AM

Step 1 Critical Step, Mobilization - Notify Gas Control the first day on site and excavations begin. Installation must conform to current Standards, Procedures and Gas Work Methods. Note: As per INR06002, new plastic or steel gas main installations in excess of 2,500 feet require a sniff check to assess the need for additional monitoring and/or supplemental odorization

Date: 06/16/2022

Time: 07:50

Gas Completed JD
Control:

Crew: Jack O'Neill

Phone: 617-719-2889

Step 2 Confirm prior to proceeding - 1) All crew members' and the inspector's qualifications have been reviewed and checked to perform covered tasks. 2) Verify job brief and training of crew has occurred specific to this SOP including AOCs and actions to mitigate AOCs.

Date: 06/16/2022

Time: 07:50

Gas Confirmed JD
Control:

Crew: Jack O'Neill

Phone: 617-719-2889

Step 3 Call in Dead Pipe SOP MMA2202185 as Complete

Date: 06/16/2022

Time: 07:50

Gas Completed JD
Control: Note work completed under MMA2200097 (RL)

Crew: Jack O'Neill

Phone: 617-719-2889

Step 4 Install 1540 ft of 2" PL. Verify all valves are open, Pressure test Main. Report Results to Gas Control.

Date: 06/16/2022

Time: 07:50

Gas Completed passed pressure test JD
Control:

Crew: Jack O'Neill

Phone: 617-719-2889

Step 5 Critical Step Connection: Close Valve NV-A, Tap 2" HVT, Report Pressures to Gas Control.

Date: 06/16/2022

Time: 07:50

Gas Starting 07:49 JD
Control: 54 PSI JD

Crew: Jack O'Neill

Phone: 617-719-2889

Step 6 Critical Step Purge Into service: Open valve NV-A and purge 1540 ft of 2" PL into service through a grounded vent stack, obtaining 3 readings of 95% gas or greater on a calibrated combustible gas indicator following approved gas work methods.

Date: 06/16/2022

Time: 09:32

Crew: Tony Cabral

Time: 12:18

Gas Complete per Jack. JR///
Control:

Crew: Jack Oneal

Phone: 6177192889

Step 13 Critical Step, Job Complete - Notify Gas Control at the completion of entire job which includes gas-in, retirements, and services transferred as appropriate in accordance with SOP steps above. **Date:** 07/08/2022

Time: 12:18

Gas Complete per Jack. JR///
Control:

Crew: Jack Oneal

Phone: 6177192889

Drawings: MMA2202459 REV # : 2

- 1308825 - Greenvale Avenue Weymouth (W.O.1308825) Live Gas SOP Sks1.pdf

Other Attachments: MMA2202459 REV # : 2

- MMA2202459 - 1308825 - 33-133 GREENVALE AV WEY SOP Combined.pdf

Attach as Built: MMA2202459 REV # : 2

Builtin Other Attachment: MMA2202459 REV # : 2

GAS SYSTEM OPERATING PROCEDURE

SOP #: MMA2202459	Rev #: 2	Date of SOP Request: 06/02/2022
--------------------------	-----------------	--

REQUESTOR INFO: MMA2202459 REV # : 2

Employee #: 72013723	Employee Name: Christian Troy	Phone #: 9782707104
Division/Business Area: Gas Contractor Oversight NE Central		Location: Braintree 5110

SOP DETAILS MMA2202459 REV # - 2

SOP Last Status: Gas Control Approved 06/06/2022	Town/Boro: WEYMOUTH
---	----------------------------

Est Start Date: 6/7/2022 12:00:00 AM	Work Order #: 1308825	Public Works #:
---	------------------------------	------------------------

Onyx #:	ID/Grid #: Grid	Cross Street 1: Greenwood Ave
----------------	------------------------	--------------------------------------

On Street: Greenvale Ave	Cross Street 2:	Sect. District valve req'd: N
---------------------------------	------------------------	--------------------------------------

Field Area: PCS	Job Type: Gas Plan/Ops Eng Rev Req'd:	PCB Wipe Rev Req'd: N
------------------------	--	------------------------------

I & R Rev Req'd: N	System Pressure: 60	Valve Tags Req'd: Y
-------------------------------	----------------------------	----------------------------

Nature Of Work: MAIN REPLACEMENT	*Critical Main N
---	-------------------------

Basic Job Description Install 1040 Ft 2"PLI by open trench and 500 ft of 2" PL via HDD, 1 connection 25 customer service accounts 1540 ft 1.5" BS abandoned

W/IN 200" of Critical Facility: NONE	If Other Please Describe:
---	----------------------------------

Call In Date:	Call In Time:	Phone:
----------------------	----------------------	---------------

Valve(s) Involved	Regulator(s) Involved
--------------------------	------------------------------

# of main connections: 1	Estimated # of customers affected: 25
---------------------------------	--

Gas Accountability: MMA2202459 REV # : 2	Initial Gas Pressure (psig): 60
---	--

Gas Accountability	Initial Gas Temperature (F): 40
---------------------------	--

Internal Pipe Diameter (in): 1.1	Final Gas Pressure (psig): 0
Recovery: N	Final Gas Temperature: 40
MCF Line Pack: 0.043	

Review Comments: MMA2202459 REV # : 2	By: Maxwell Fan
Engineering Analyzed	Jumper Sizing: n/a
Temperature: 45F	Phone: 781-996-8021
	Date: 06/06/2022

STEPS NEED TO BE TAKEN: MMA2202459 REV #: 2
Minimum Operating Pressure: 51 PSIG Temperature: 45F Min Pres/Temp Last Updated: 08/06/2022 10:42 AM

Step 1 Critical Step, Mobilization - Notify Gas Control the first day on site and excavations begin. Installation must conform to current Standards, Procedures and Gas Work Methods. Note: As per JNR06002, new plastic or steel gas main installations in excess of 2,500 feet require a sniff check to assess the need for additional monitoring and/or supplemental odorization

Date:
Time:

Gas Control:

Crew:
Phone:

Step 2 Confirm prior to proceeding - 1) All crew members' and the inspector's qualifications have been reviewed and checked to perform covered tasks. 2) Verify job brief and training of crew has occurred specific to this SOP including AOCs and actions to mitigate AOCs.

Date:
Time:

Gas Control:

Crew:
Phone:

Step 3 Call in Dead Pipe SOP MMA2202185 as Complete

Date:
Time:

Gas Control:

Crew:
Phone:

Step 4 Install 1540 ft of 2" PL, Verify all valves are open, Pressure test Main, Report Results to Gas Control.

Date:
Time:

Gas Control:

Crew:
Phone:

Step 5 Critical Step Connection: Close Valve NV-A, Tap 2" HVT, Report Pressures to Gas Control.

Date:
Time:

Gas Control:

Crew:
Phone:

Gas Control:

Time:
Crew:
Phone:

Step 12 PURGING MAIN OUT OF SERVICE - CRITICAL STEP - NOTIFY GAS CONTROL. Purge gas main on Greenvale Ave from Greenwood Ave to EOM @ 133 Greenvale Ave out of service using approved Gas Work Methods, Cut and Cap NOTIFY Gas Control when complete.

Date:
Time:

Gas Control:

Crew:
Phone:

Step 13 Critical Step, Job Complete - Notify Gas Control at the completion of entire job which includes gas-in, retirements, and services transferred as appropriate in accordance with SOP steps above.

Date:
Time:

Gas Control:

Crew:
Phone:

Drawings: MMA2202459 REV # : 2

• 1308825 - Greenvale Avenue Weymouth (W.O.1308825) Live Gas SOP Sks1.pdf

Other Attachments: MMA2202459 REV # : 2

Attach as Bulk: MMA2202459 REV # : 2

Built-in Other Attachment: MMA2202459 REV # : 2



6/14/2022

Gas Control:

Time:
Crew:
Phone:

Step 12 PURGING MAIN OUT OF SERVICE - CRITICAL STEP - NOTIFY GAS CONTROL. Purge gas main on Greenville Ave from Greenwood Ave to EOM @ 133 Greenville Ave out of service using approved Gas Work Methods, Cut and Cap NOTIFY Gas Control when complete.

Date:
Time:

Gas Control:

Crew:
Phone:

Step 13 Critical Step, Job Complete - Notify Gas Control at the completion of entire job which includes gas-in, retirements, and services transferred as appropriate in accordance with SOP steps above.

Date:
Time:

Gas Control:

Crew:
Phone:

Drawings: MMA2202459 REV #: 2

- 1308825 - Greenville Avenue Weymouth (W.O.1308825) Live Gas SOP Sks 1.pdf

Other Attachments: MMA2202459 REV #: 2

Attach as Built: MMA2202459 REV #: 2

Built/In Other Attachment: MMA2202459 REV #: 2

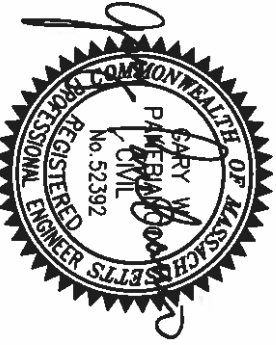

6/14/2022

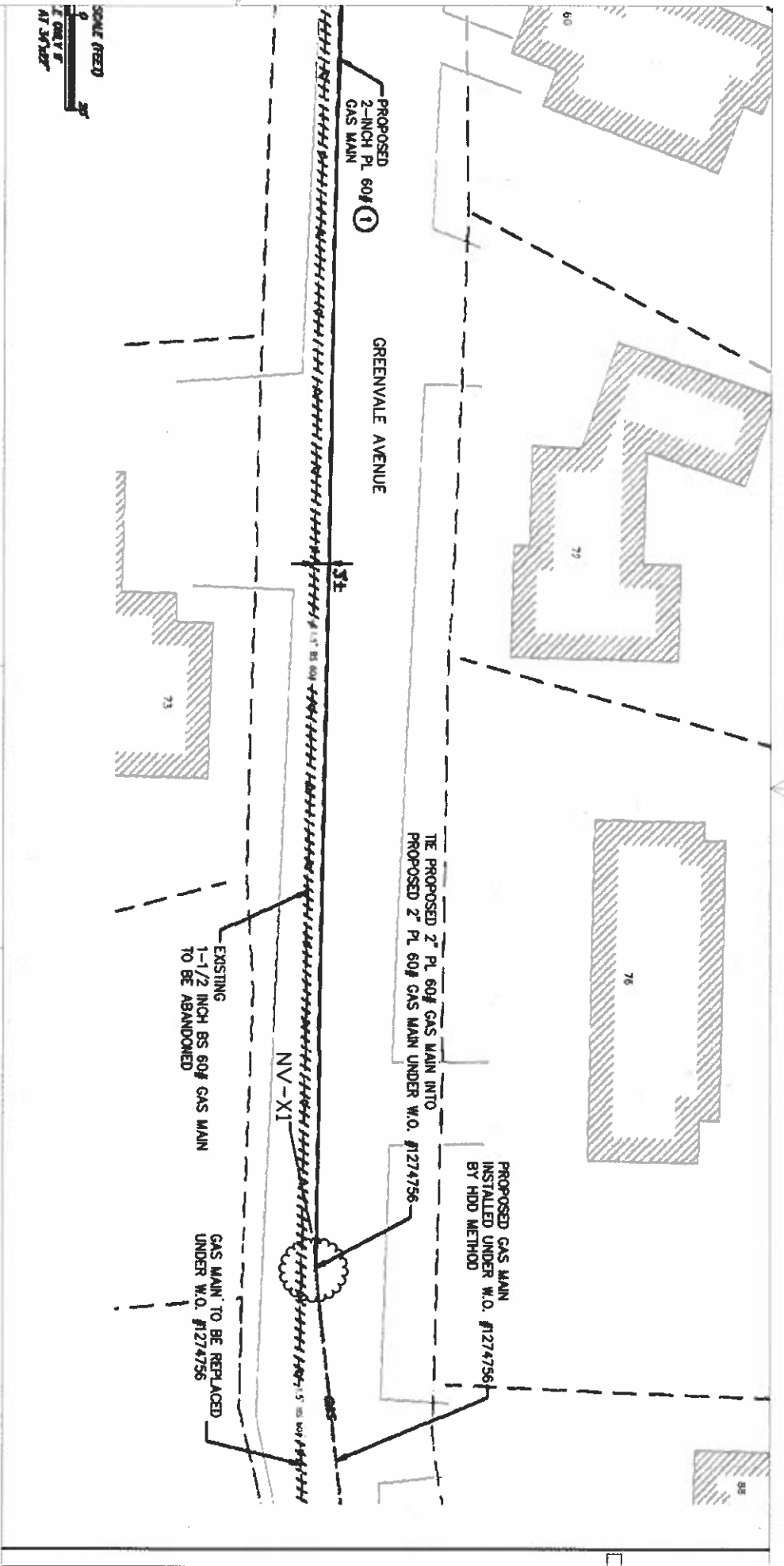

SOP MMA2202459
 1540 Ft 2" PL
 National Grid Gas Control
 508-421-7573

Overview

2

WO# 1308825

STREET	Greenvale Ave		
TOWN	WEY		
CONNECTIONS	1	SERVICES	25
SCALE	NONE		

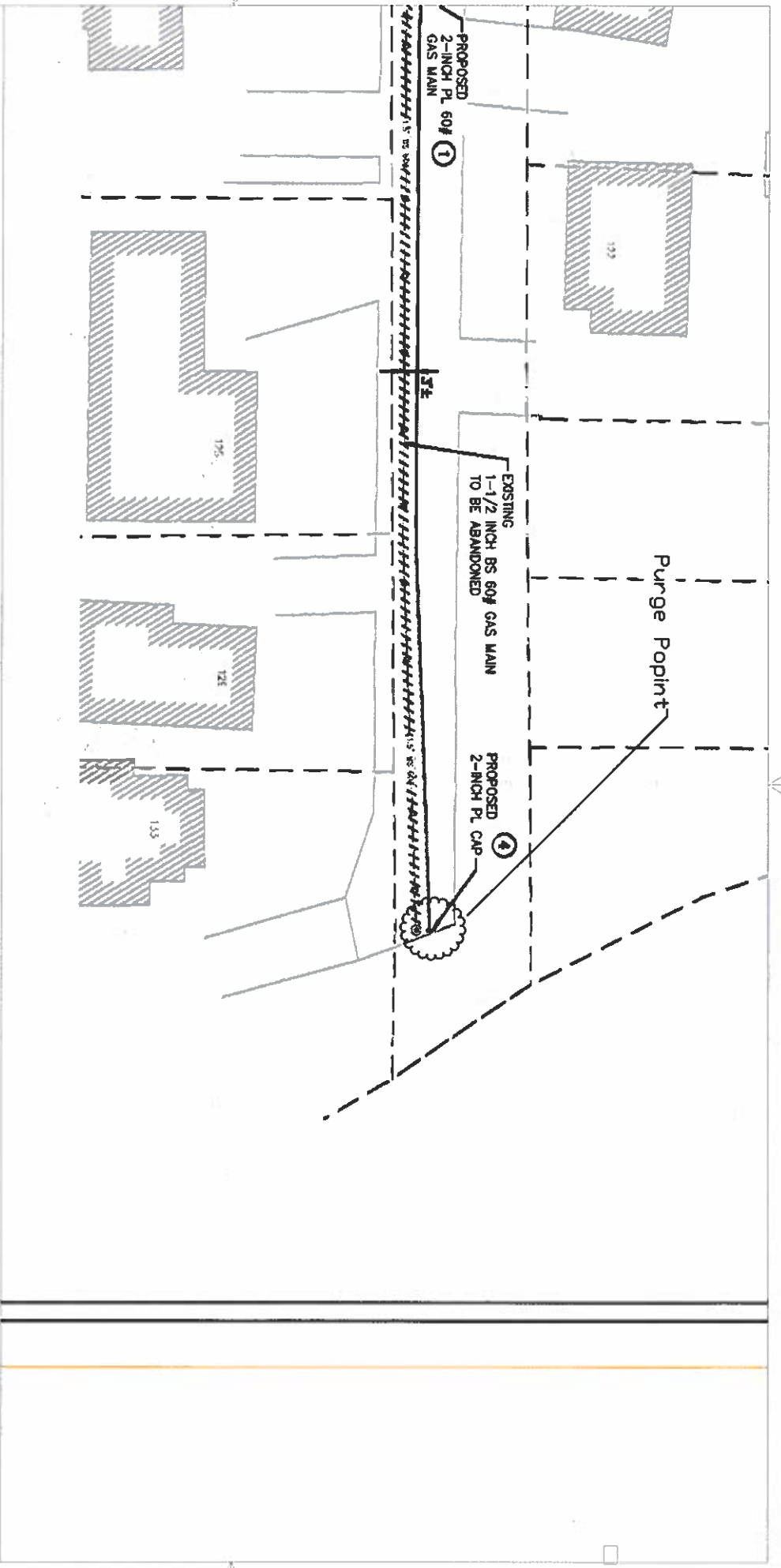

SOP MMA2202459
1540 Ft 2" PL
National Grid Gas Control
508-421-7573

Overview

4

WO# 1308825

STREET		Greenvale Ave	
TOWN		WEY	
CONNECTIONS	1	SERVICES	25
SCALE	NONE		

© VHB

Photography Log Final Site Inspection

PROJECT NUMBER

14959.00

CLIENT

Boston Gas Company

40 Sylvan Road

Waltham, MA 02451

LOCATION

Greenvale Ave

Weymouth, MA 02188



NO. 1 / AUGUST 17, 2022

DESCRIPTION

View looking south at Greenvale Avenue towards the culvert crossing location.



NO. 2 / AUGUST 17, 2022

DESCRIPTION

View looking northeast at the headwall of the unnamed stream that runs beneath Greenvale Avenue.



NO. 3 / AUGUST 17, 2022

DESCRIPTION

View looking northwest at the headwall on the west side of Greenville Avenue associated with the unnamed perennial stream.



NO. 4 / AUGUST 17, 2022

DESCRIPTION

View looking north at Greenville Avenue at the culvert crossing location.