

# WEYMOUTH FORE RIVER

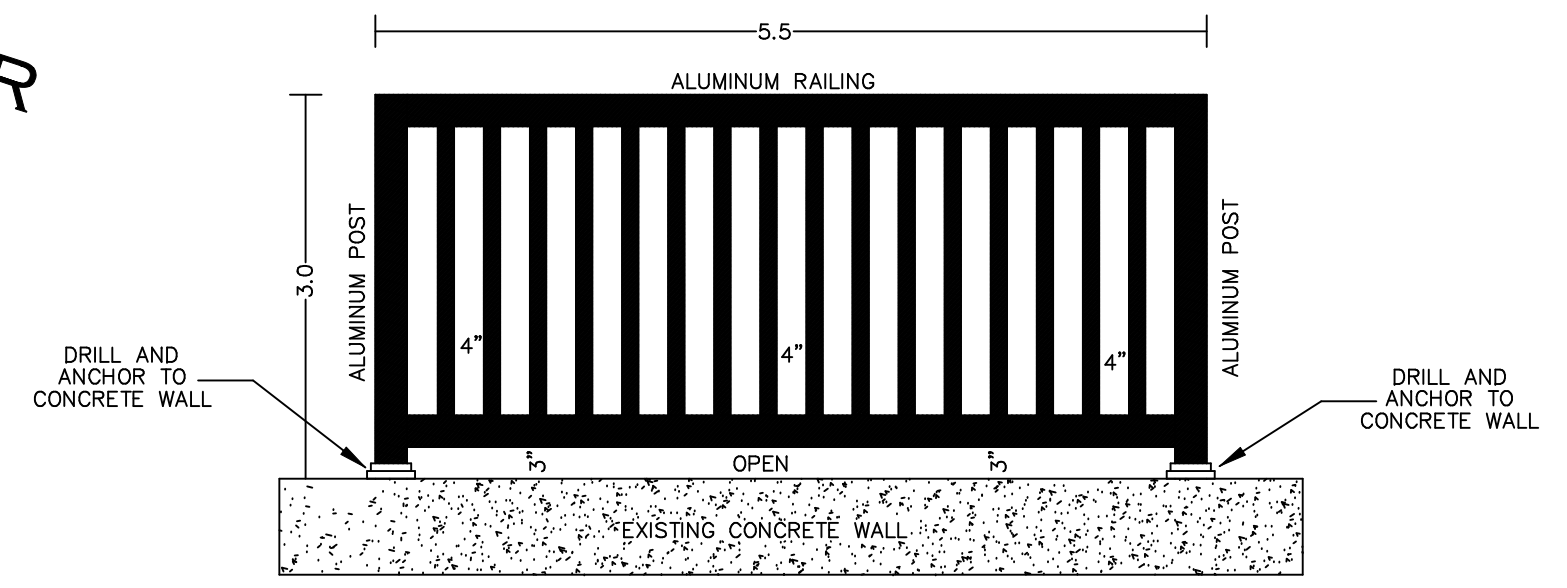

**RAILING DETAIL**  
NOT TO SCALE

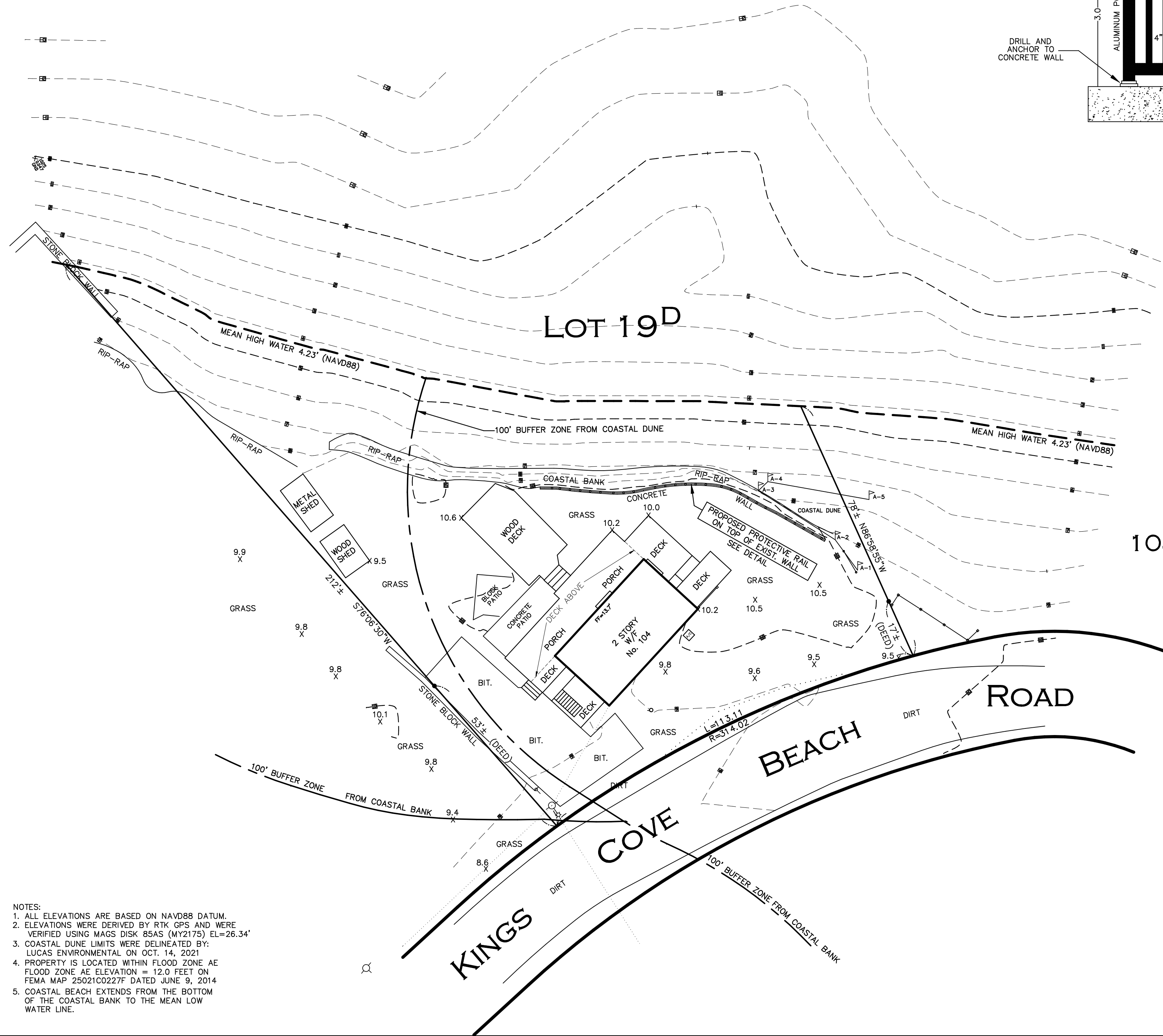
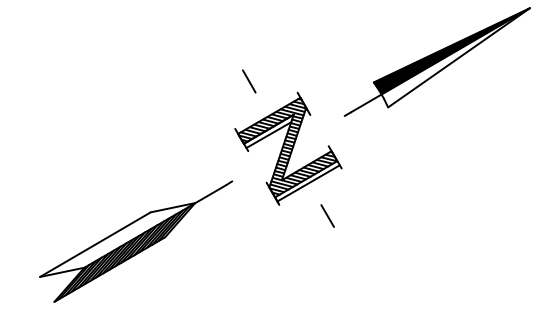

## SITE PLAN FOR 104 KINGS COVE BEACH ROAD IN WEYMOUTH, MASS.

PREPARED BY:  
**JAMES NABSTEDT PLS**  
16 CONNELL STREET QUINCY, MASS.  
~~DECEMBER 10, 2021~~ SCALE 1" = 20'  
MARCH 14, 2022

JAMES L. NABSTEDT PLS No. 39693

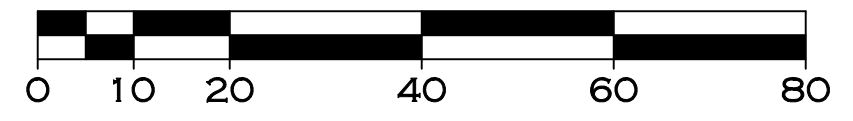

- NOTES:
1. ALL ELEVATIONS ARE BASED ON NAVD88 DATUM.
  2. ELEVATIONS WERE DERIVED BY RTK GPS AND WERE VERIFIED USING MAGS DISK 85AS (MY2175) EL=26.34'
  3. COASTAL DUNE LIMITS WERE DELINEATED BY: LUCAS ENVIRONMENTAL ON OCT. 14, 2021
  4. PROPERTY IS LOCATED WITHIN FLOOD ZONE AE FLOOD ZONE AE ELEVATION = 12.0 FEET ON FEMA MAP 25021C0227F DATED JUNE 9, 2014
  5. COASTAL BEACH EXTENDS FROM THE BOTTOM OF THE COASTAL BANK TO THE MEAN LOW WATER LINE.