

LEGEND

- MEAN HIGH WATER EL. = 11'
- BORDERING VEGETATED WETLAND
- 100-YEAR FLOOD EL. = 17.88'
- SALT MARSH
- ◆ B-# PROPOSED BORINGS

NOTE
1. THE ENTIRE PROJECT SITE IS LOCATED WITHIN THE 200' RIVERFRONT AREA BUFFER ZONE AND THE 100' WETLAND BUFFER ZONE.

	ENVIRONMENTAL PARTNERS — An Apex Company —			Scale	1" = 20'		LOWER CENTRAL INTERCEPTOR IMPROVEMENTS WEYMOUTH, MASSACHUSETTS EXISTING CONDITIONS I	FOR PERMITTING
			MARK	DATE	DESCRIPTION			Date MAY 2023 Job No. 290-2101 Designed by SLC Drawn by SLC Checked by RJA Approved by RJA

Drawing file: C:\Users\local_Sabrina.Catanesa\Temp\A\Publish_2379601_Existing Conditions - Borings NDI.dwg Plot Date: May 10, 2023 3:10pm

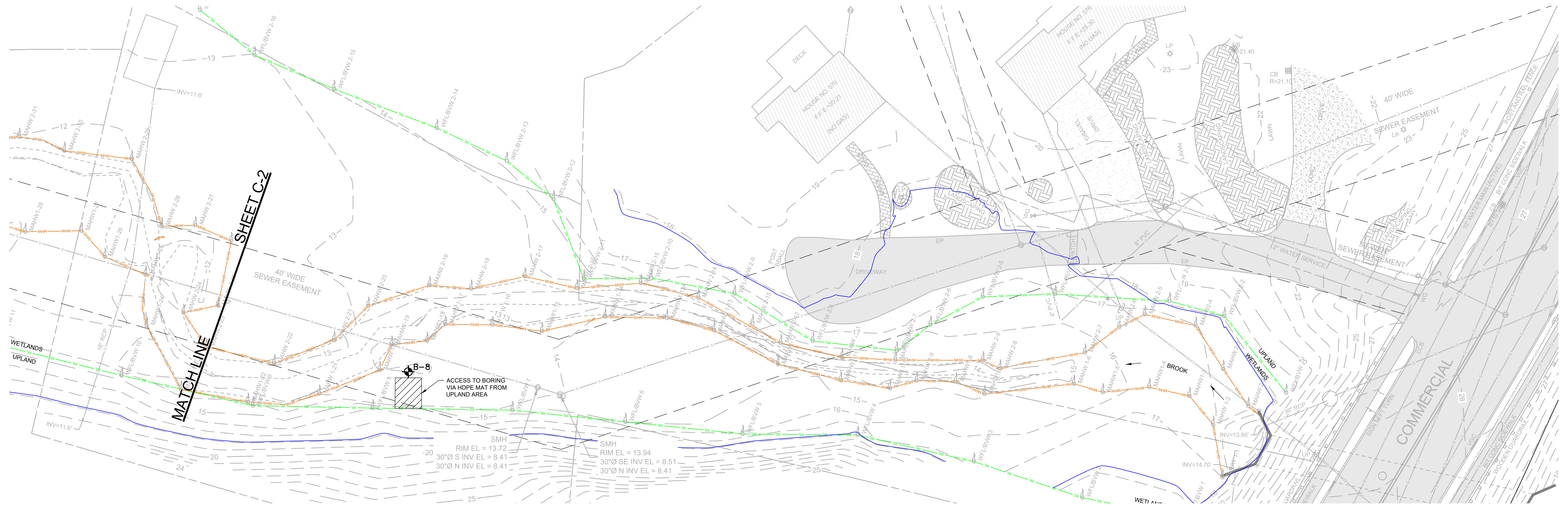
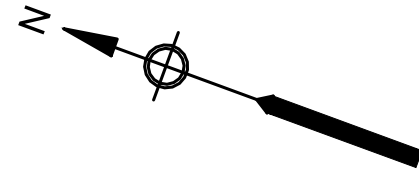

PLAN
SCALE: 1" = 20'

LEGEND

- MEAN HIGH WATER EL. = 11'
- 100-YEAR FLOOD EL. = 17.88'
- BORDERING VEGETATED WETLAND
- PROPOSED BORINGS

NOTE
1. THE ENTIRE PROJECT SITE IS LOCATED WITHIN THE 200' RIVERFRONT AREA BUFFER ZONE.

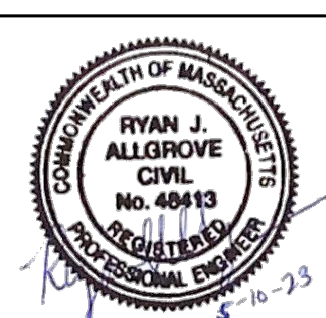
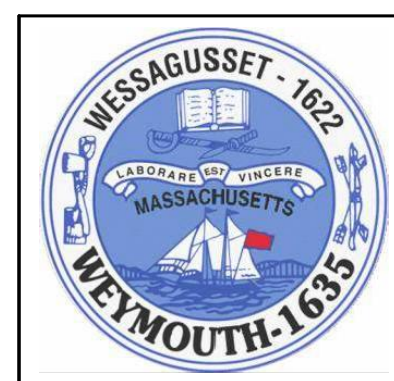

MARK	DATE	DESCRIPTION

Scale	1" = 20'
Date	MAY 2023
Job No.	290-2101
Designed by	SLC
Drawn by	SLC
Checked by	RJA
Approved by	RJA

THIS LINE IS ONE INCH LONG WHEN PLOTTED AT FULL SCALE ON A 22" X 34" DRAWING

LOWER CENTRAL INTERCEPTOR IMPROVEMENTS
WEYMOUTH, MASSACHUSETTS

EXISTING CONDITIONS II

FOR PERMITTING

Sheet No.

C-2