

NOTES:

- 1. PROPERTY LINE INFORMATION TAKEN FROM PLAN OF "HOLY ESTATES EXTENSION" RECORDED IN PLAN BOOK 445, PLAN 114.
- 2. WETLANDS DELINEATION BY PINEBROOK CONSULTING.

Plan of Land
in
WEYMOUTH, MASS.

owned by
Richard W. & Doreen Foster
Scale: 1 in. = 20 ft. April 26, 2021

C.W. GARVEY CO., INC.
SURVEYORS AND ENGINEERS
36 WEST STREET
WHITMAN, MASS.

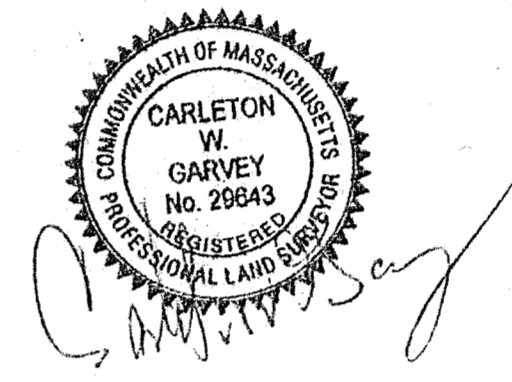

13 ASHLEY CIRCLE
ANNA & CIRO PIRONE

79 SHERI LANE
STEPHEN & KERRY WINROW

Lot E-9
25,002 s.f.

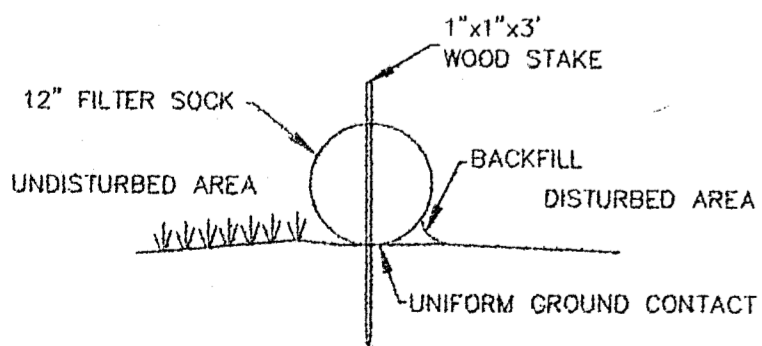

Erosion Control Barrier