

# CONSERVATION PLAN PROPOSED BUFFER ZONE RESTORATION

655 Washington Street, Weymouth, MA

Date: April 9, 2021

Prepared by: Environmental Consulting & Restoration, LLC

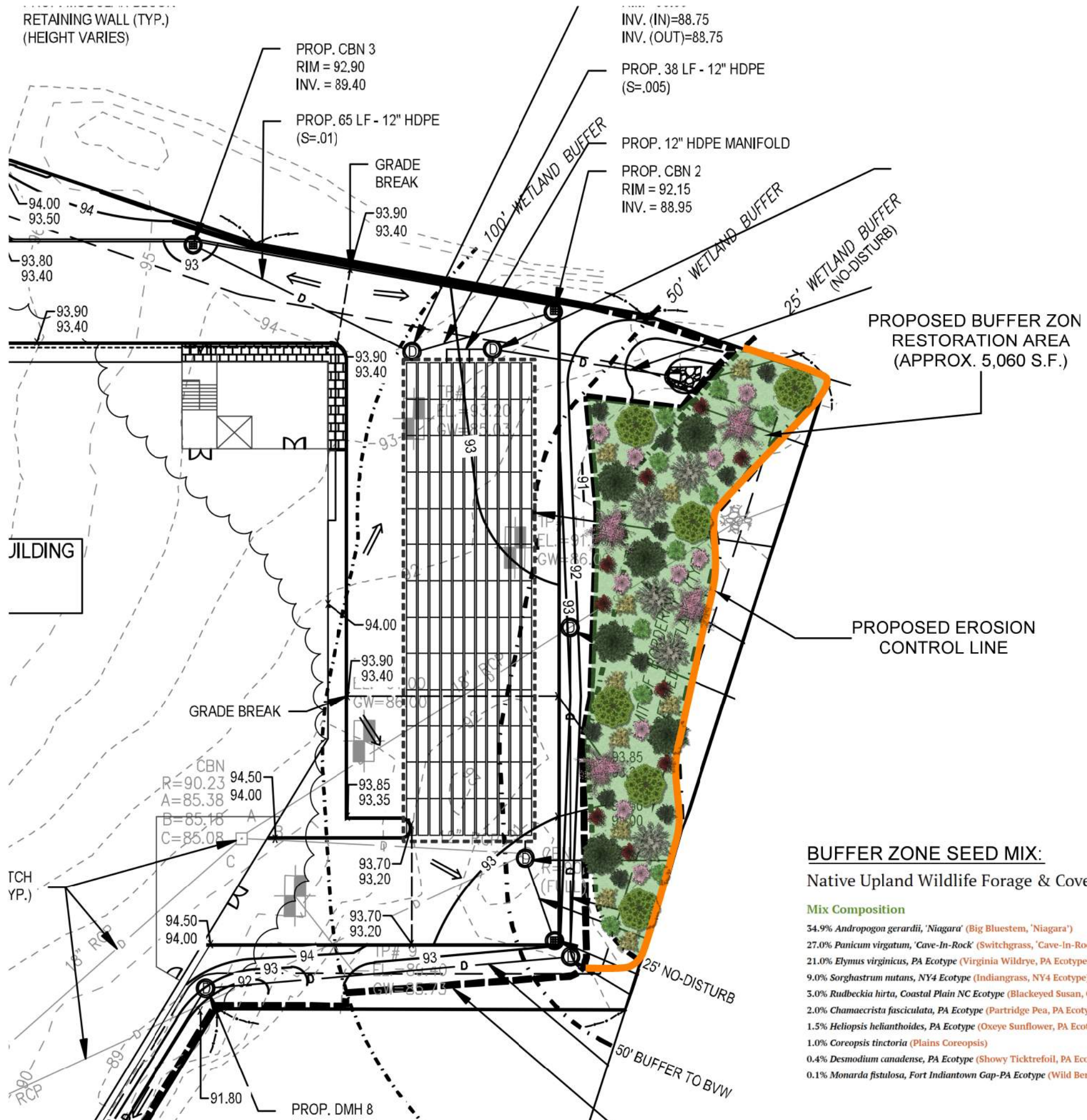

## BUFFER ZONE RESTORATION TASKS

1. Install erosion controls along the edge of the Bordering Vegetated Wetland.
2. Cut the existing non-native invasive plants within the designated buffer zone restoration area. The existing vegetation within the buffer zone that consists entirely of non-native invasive plants such as Black Locust, Tree of Heaven, Japanese Knotweed, etc. Upon cutting, all cut vegetation should be removed from the site and disposed of at a facility familiar with processing of invasive plants.
3. Using a small machine, all debris, concrete piles, old fill piles, etc. should be removed from the designated buffer zone restoration area.
4. Using a small machine, the stumps and root zone of the cleared vegetation should be grubbed out, collected, and disposed of at a facility familiar with processing of invasive plants.
5. Cover the designated buffer zone restoration area with clean loam. The supplier of the loam should verify that the loam to be imported to the site is free of invasive plant/seeds.
6. Revegetate the area with native saplings and shrubs as shown on the plan. Plant spacing shall be in accordance with DEP guidance to include shrubs spaced 10 feet on center and saplings 15 feet on center. In order to revegetate the 5,060 square foot restoration area a total of 59 shrubs and 26 saplings are proposed to be planted. The remaining restoration area shall be scratched and seeded with a native buffer zone seed mix (see seed mix profile).
7. Monitoring of the restoration area shall be completed in accordance with the anticipated Order of Conditions and shall include monitoring of non-native invasive species. Any non-native invasive species shall be hand pulled and disposed of offsite at appropriate facility

## BUFFER ZONE SEED MIX:

Native Upland Wildlife Forage & Cover Meadow Mix

### Mix Composition

- 34.9% *Andropogon gerardii*, 'Niagara' (Big Bluestem, 'Niagara')
- 27.0% *Panicum virgatum*, 'Cave-In-Rock' (Switchgrass, 'Cave-In-Rock')
- 21.0% *Elymus virginicus*, PA Ecotype (Virginia Wildrye, PA Ecotype)
- 9.0% *Sorghastrum nutans*, NY4 Ecotype (Indiangrass, NY4 Ecotype)
- 5.0% *Rudbeckia hirta*, Coastal Plain NC Ecotype (Blackeyed Susan, Coastal Plain NC Ecotype)
- 2.0% *Chamaecrista fasciculata*, PA Ecotype (Partridge Pea, PA Ecotype)
- 1.5% *Heliopsis helianthoides*, PA Ecotype (Oxeye Sunflower, PA Ecotype)
- 1.0% *Coreopsis tinctoria* (Plains Coreopsis)
- 0.4% *Desmodium canadense*, PA Ecotype (Showy Ticktrefoil, PA Ecotype)
- 0.1% *Monarda fistulosa*, Fort Indiantown Gap-PA Ecotype (Wild Bergamot, Fort Indiantown Gap-PA Ecotype)

## Plant Legend

Symbol	Qty	Common	Botanical	Size
	11	Lowbush Blueberry	<i>Vaccinium angustifolium</i>	1-1.5 ft.
	12	Black Chokeberry	<i>Aronia melanocarpa</i>	2-3 ft.
	12	Chokecherry	<i>Prunus virginiana</i>	2-3 ft.
	12	Mountain Laurel	<i>Kalmia latifolia</i>	2-3 ft.
	12	Witch Hazel	<i>Hamamelis virginiana</i>	2-3 ft.
	6	Black Cherry	<i>Prunus serotina</i>	5-6 ft.
	7	Black Oak	<i>Quercus velutina</i>	5-6 ft.
	7	Eastern Red Cedar	<i>Juniperus virginiana</i>	5-6 ft.
	6	Flowering Dogwood	<i>Cornus florida</i>	5-6 ft.